

## Text Effect Movie Clips

You can set special text effects as a movie clip then import them into web pages. For example, you might want an animated logo or a message flashing across the screen.

### Creating the Movie Clip Symbol

The first step in the process is to create the movie clip symbol.

- 1 Load Flash or close the current file and create a new ACTIONSCRIPT 3.0 file.
- 2 Display the INSERT menu and select NEW SYMBOL.

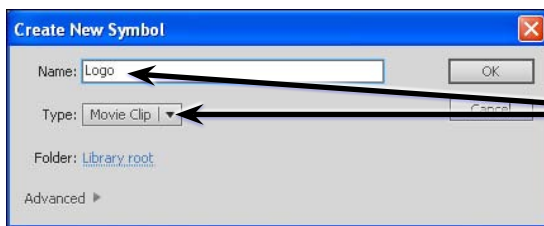

- 3 Name the symbol LOGO and set the TYPE to MOVIE CLIP.

- 4 Select OK and your screen will be set to MOVIE CLIP EDIT MODE.

### Entering the Text

Some text will be entered then broken apart and distributed to layers so that each letter is in a separate layer. Once this is completed each letter can be animated.

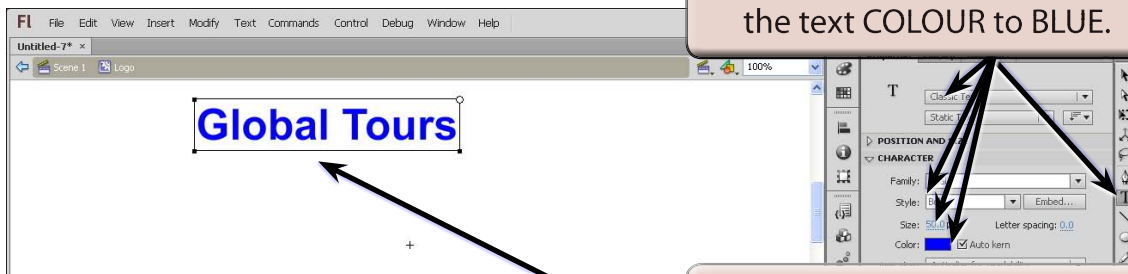

- 1 Select the TEXT TOOL, set the TEXT ENGINE to CLASSIC TEXT, the STYLE to BOLD, the SIZE to 50 point and the text COLOUR to BLUE.

- 2 Click the I-Beam on the stage and enter:

Global Tours

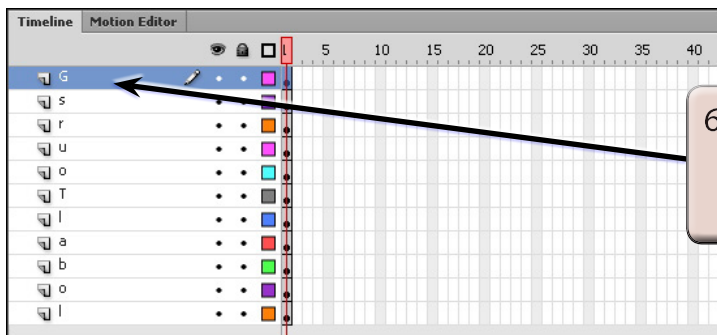
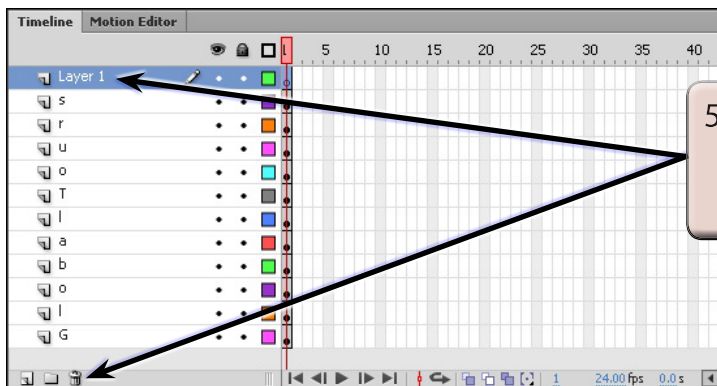
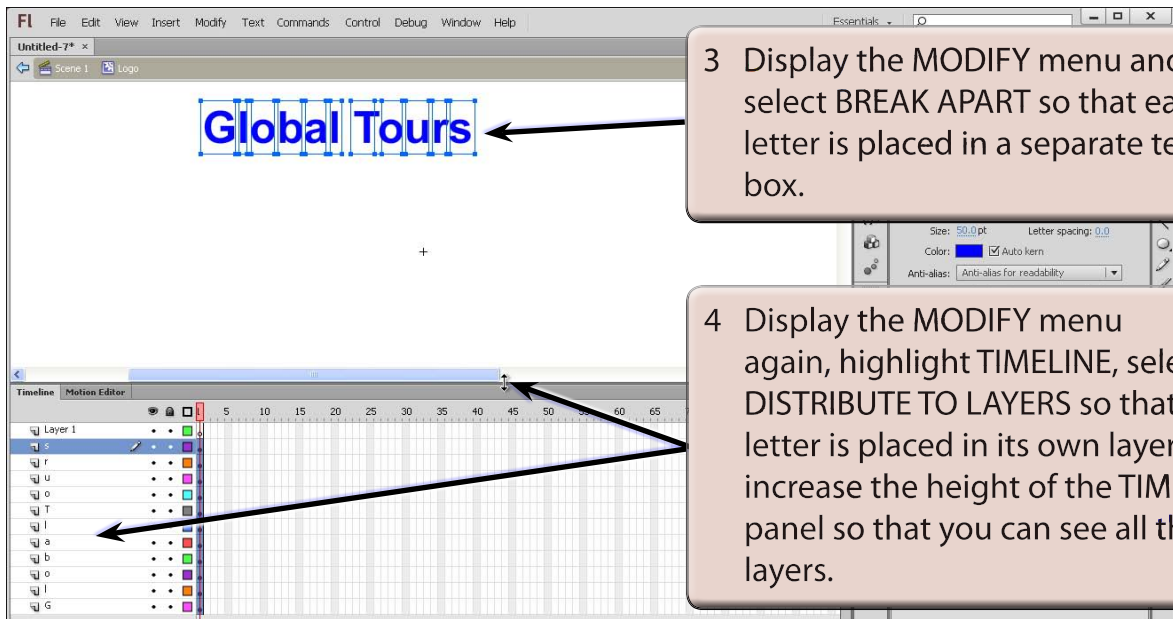

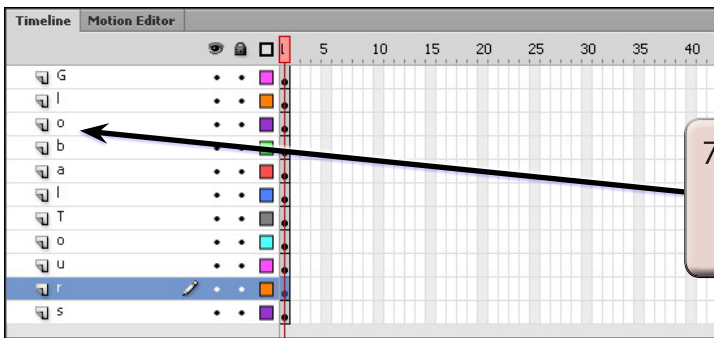

7 Repeat step 6 to move the other layers so that they are in the same order as the letters in the words.

## Adding Keyframes

Keyframes will be added to each layer. This can be done in one step.

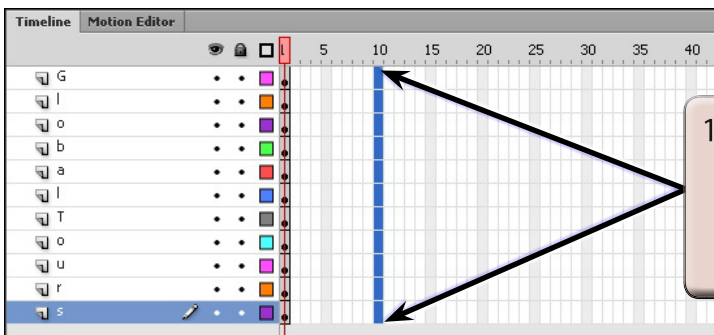

1 Highlight FRAME 10 for each layer by dragging the pointer from FRAME 10 of the G layer to FRAME 10 of the last L layer.

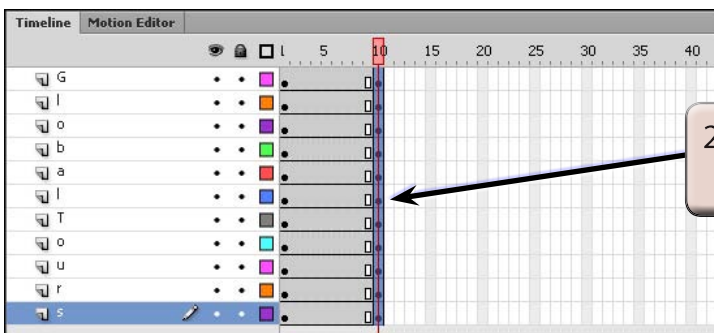

2 Press the F6 key to insert the KEYFRAMES.

**NOTE:** KEYFRAMES should be added to FRAME 10 of each layer along with normal frames up to FRAME 10.

## Animating the Letters

We want the G to come on the screen first followed by the L then the O, etc.

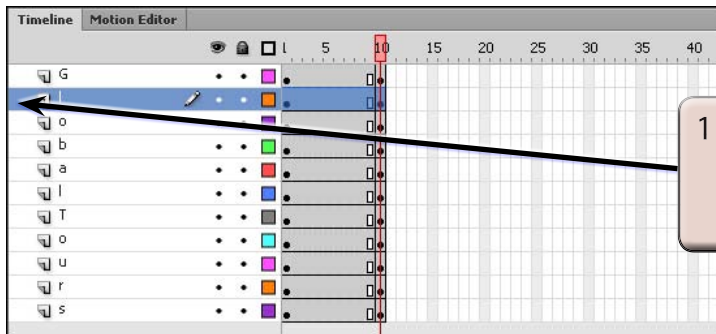

1 Click to the left of the first L layer icon (the second layer) to highlight all its frames.

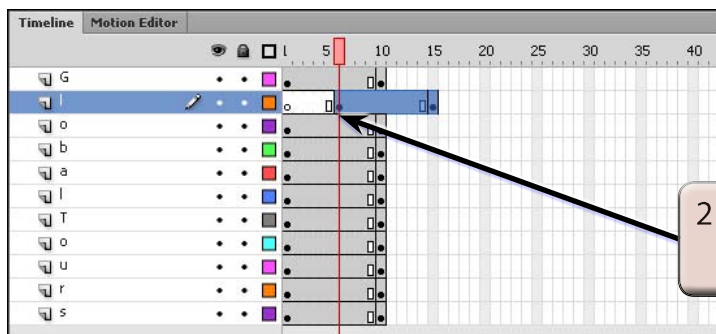

2 Drag the KEYFRAME MARKER at FRAME 1 for the L layer to FRAME 6.

**NOTE:** All of the frames for the L layer should move to the right. This will cause the L to be placed on the stage 5 frames after the G.