

# Artistic Brushes

Photoshop CS6 provides extensive artistic brushes that can be used to create artwork from scratch or convert photos to artwork. There are three different types of brushes available, Regular Brushes that you used in Module 1, Bristle Tip Brushes that will be demonstrated in this Chapter and Mixer Brushes, which will be covered in the next Chapter.

## Starting a New Document

- 1 Load Photoshop or close the current files then display the FILE menu and select NEW.

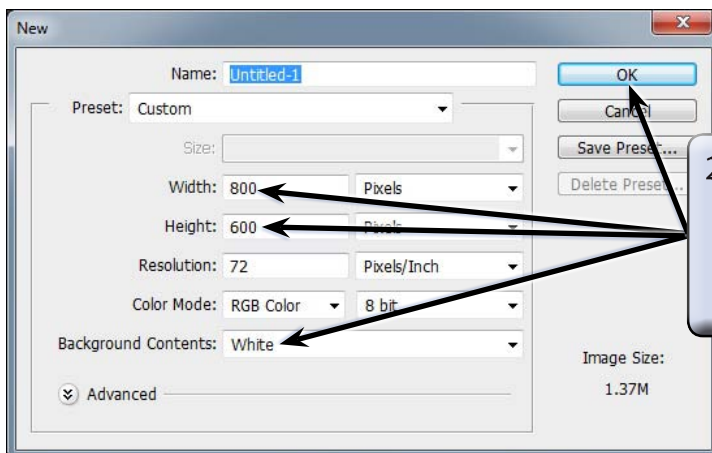

- 2 Set the WIDTH to 800 pixels, the HEIGHT to 600 pixels, the BACKGROUND CONTENTS to WHITE and select OK.

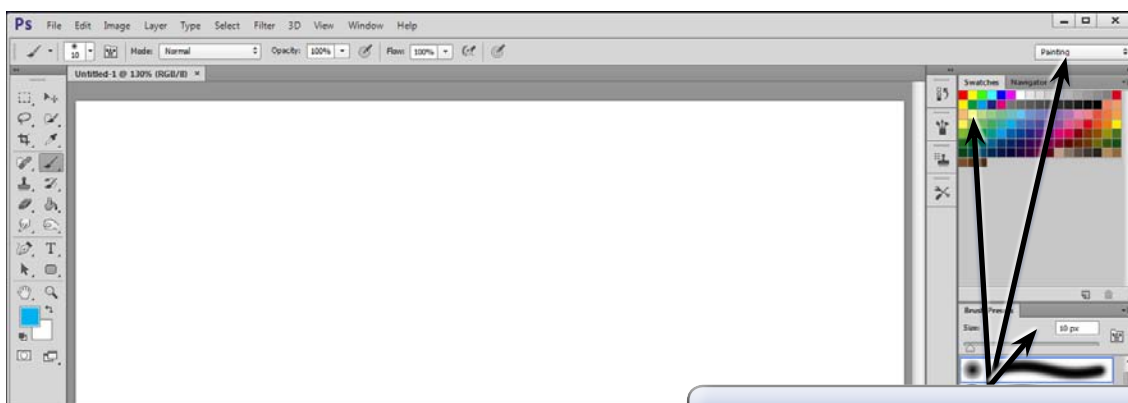

- 3 Set the screen to the PAINTING workspace which will display the SWATCHES and BRUSH PRESETS panels in the PANEL GROUP.

## Regular Brushes

The use of regular brushes will be briefly revised.

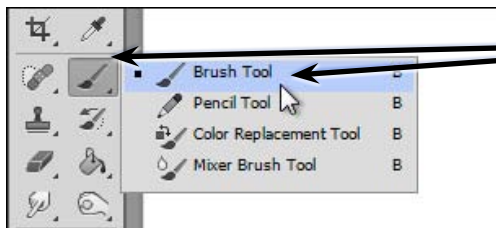

1 Set the TOOLS panel to 2 columns and select the BRUSH TOOL.

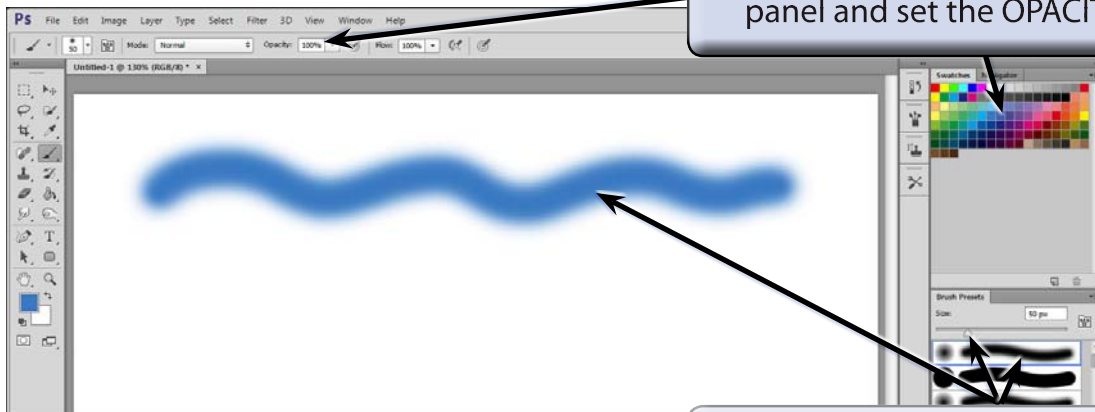

2 Select a colour from the SWATCHES panel and set the OPACITY to 100%.

3 Select the first brush in the BRUSH PRESETS panel, drag the SIZE slider to about 50 px and draw a line on the canvas.

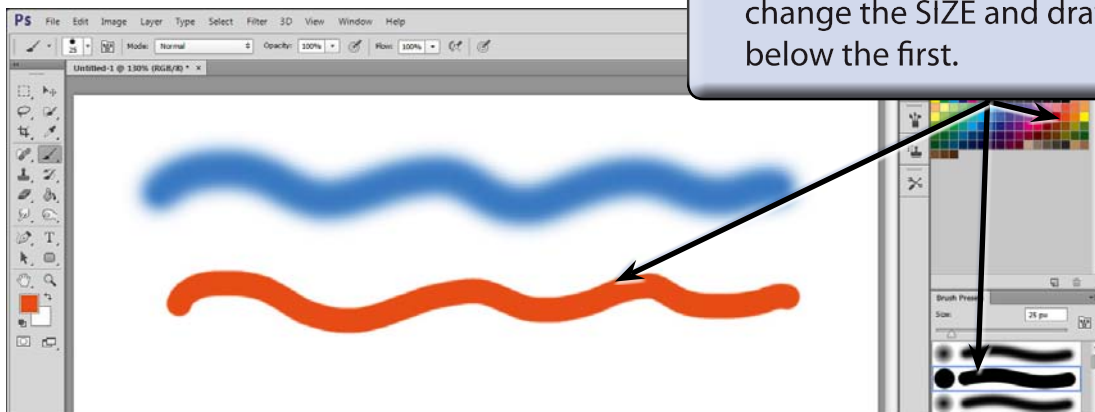

4 Select a different colour, the second brush in the BRUSH PRESETS panel, change the SIZE and draw a line below the first.

## The Eyedropper Tool

The EYEDROPPER TOOL allows you to select colours from the canvas then paint with the selected colour. It is often used in conjunction with the BRUSH TOOL when creating artwork.

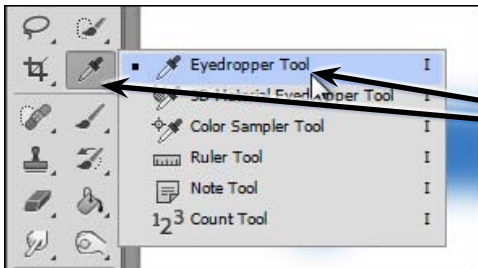

1 Select the EYEDROPPER TOOL from the TOOLS panel.

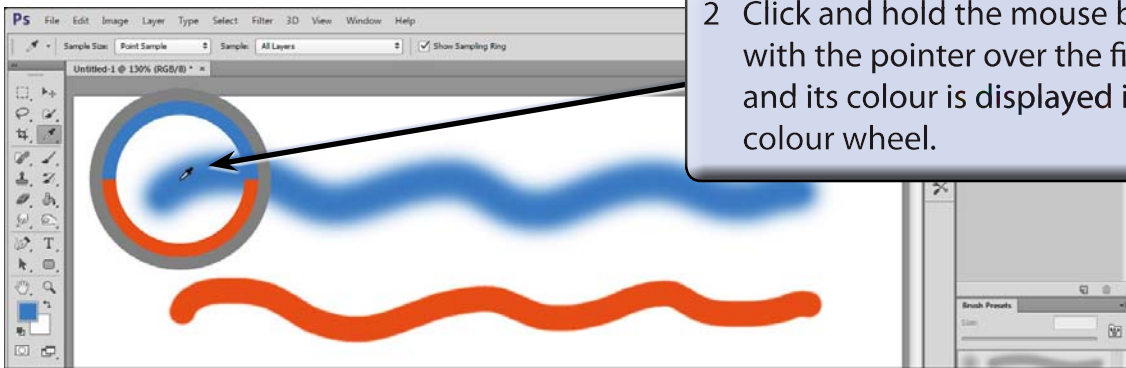

2 Click and hold the mouse button with the pointer over the first line and its colour is displayed in the colour wheel.

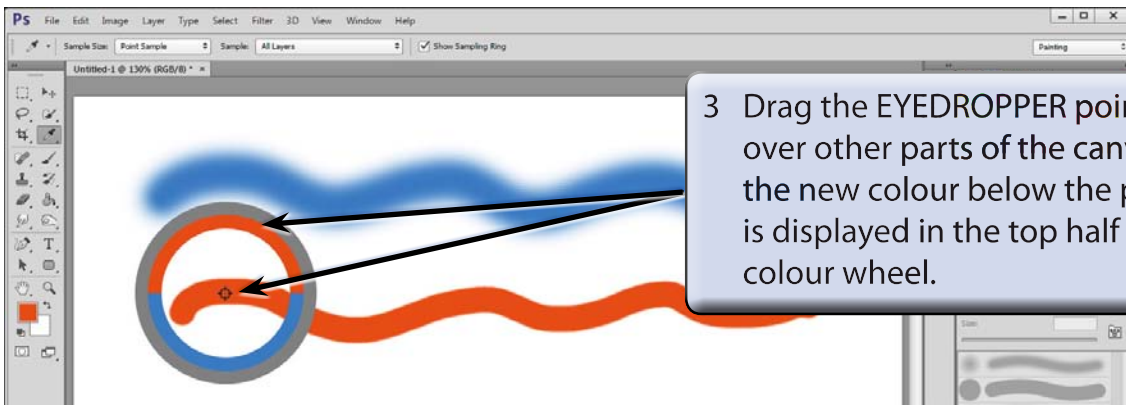

3 Drag the EYEDROPPER pointer over other parts of the canvas and the new colour below the pointer is displayed in the top half of the colour wheel.

- 4 On the Windows system hold down the ALT and SHIFT keys and press the RIGHT MOUSE BUTTON. On the MACINTOSH system hold down the CONTROL, OPTION and COMMAND keys.

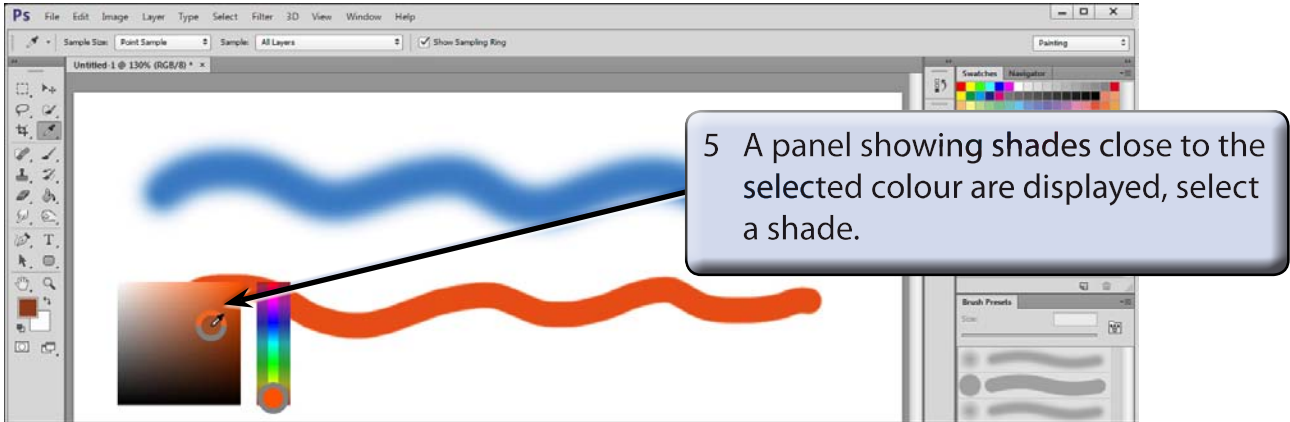

- 6 Select the BRUSH TOOL and paint a line with the selected colour.

## Bristle Tip Brushes

Bristle Tip Brushes provide many more drawing options than Regular Brushes.

### A Clearing the Canvas

- 1 Press CTRL+A or COMMAND+A to select all the contents of the canvas and press the DELETE key.

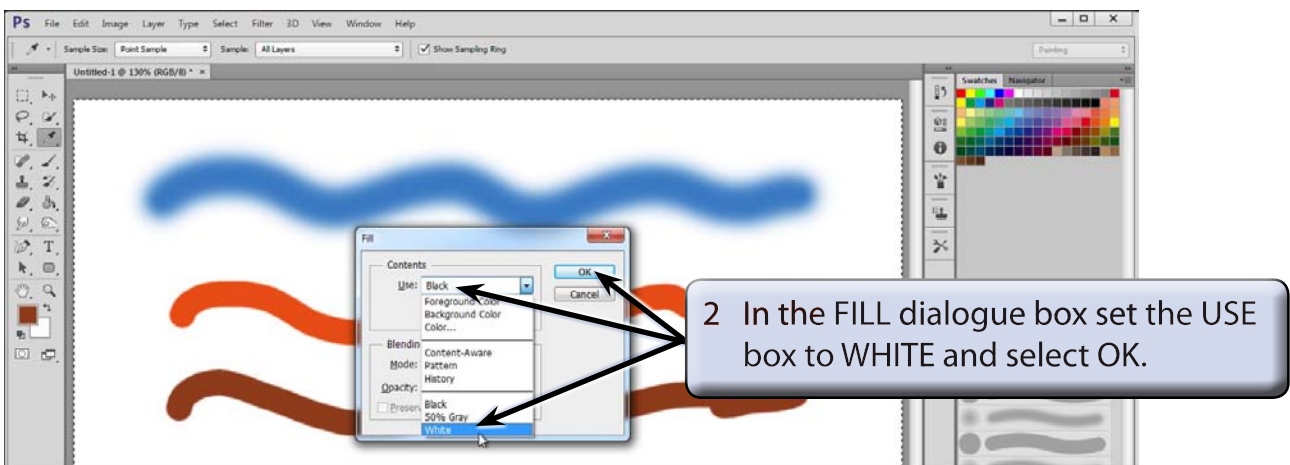

- 3 Press CTRL+D or COMMAND+D to deselect the selection around the edge of the canvas.

## B Selecting a Bristle Tip Brush

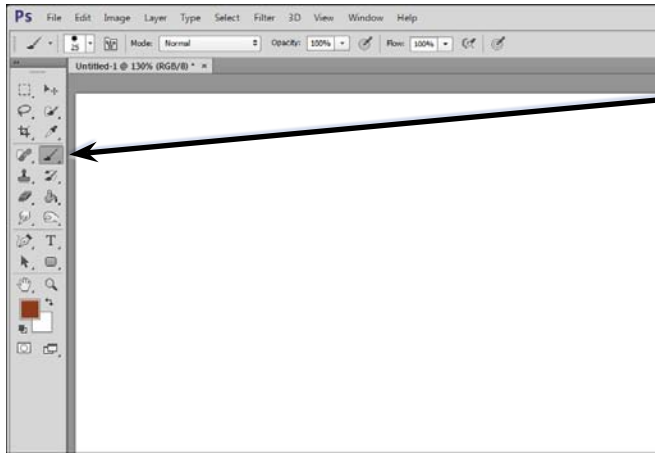

1 Select the BRUSH TOOL and scroll down the brushes in the BRUSH PRESETS panel until you come to brushes with brush icons next to them.

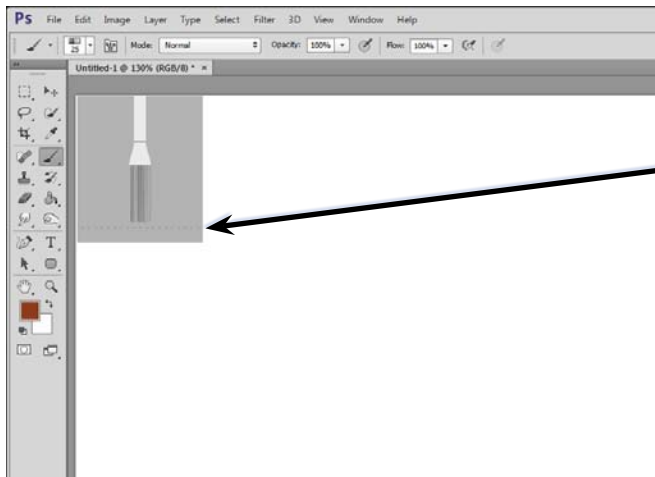
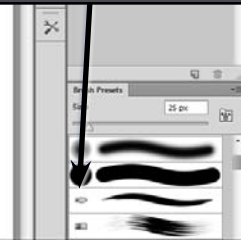

2 Select the ROUND BLUNT MEDIUM STIFF brush and the BRUSH PREVIEW is added to the screen.

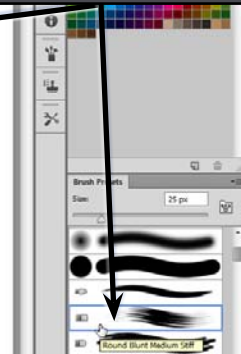

- NOTE:**
- i You can distinguish a BRISTLE TIP BRUSH from a REGULAR BRUSH by the icon next to it in the BRUSH PRESETS panel and the BRUSH PREVIEW is only available for BRISTLE TIP BRUSHES.
  - ii If the BRUSH PREVIEW is not displayed, click on the TOGGLE THE LIVE TIP BRUSH PREVIEW icon at the bottom left of the BRUSH PRESETS panel to display it.