

Combining Shapes

You can add or subtract one shape to or from another. This can help in the adding of drawings to photos and in the creation of designs, logos, T-shirt iron-on transfers, etc.

Starting a New Document

- 1 Load Photoshop Elements or close the current files.
- 2 Display the FILE menu, highlight NEW and select BLANK FILE.

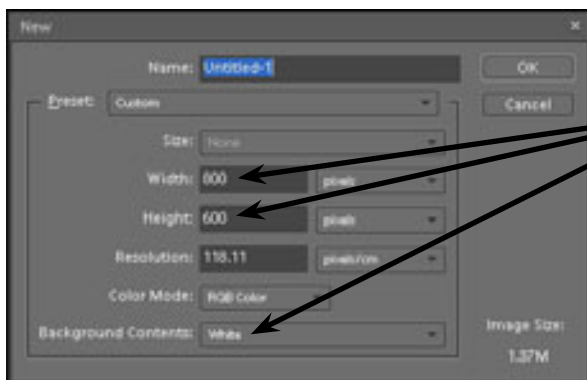

- 3 Set the WIDTH to 800 pixels, the HEIGHT to 600 pixels and the BACKGROUND CONTENTS to WHITE.

- 4 Select OK to start the new document.

Creating a Combined Shape

A Shape will be created that combines a number shapes.

A Drawing a Rectangle

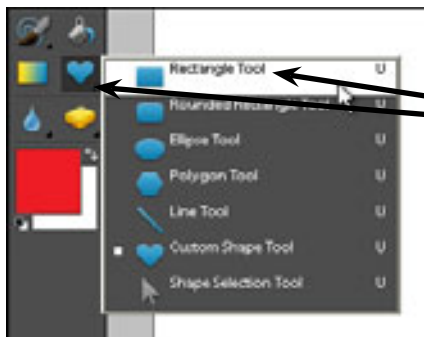

- 1 Click and hold the mouse button on the SHAPES TOOL in the TOOLS palette and select the RECTANGLE TOOL from the pop-up list of tools.

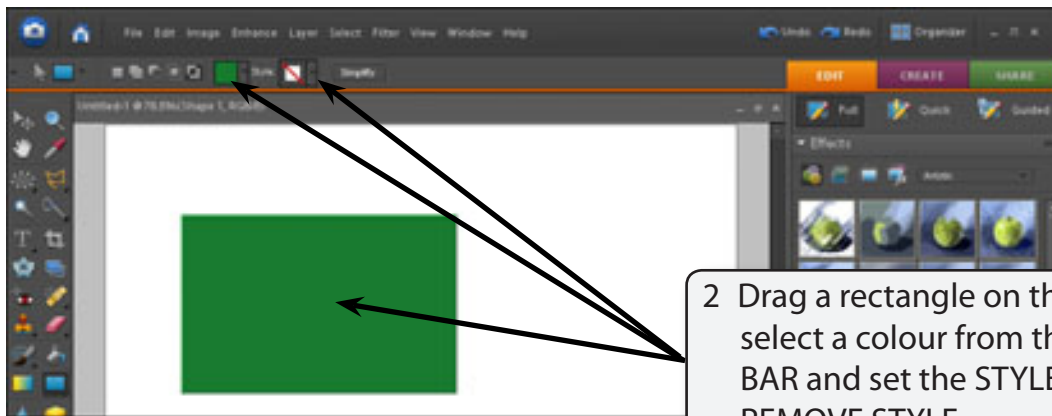

2 Drag a rectangle on the screen, select a colour from the OPTIONS BAR and set the STYLE box to REMOVE STYLE.

B Cutting a Shape Out of the Rectangle

A custom shape can be cut from the rectangle.

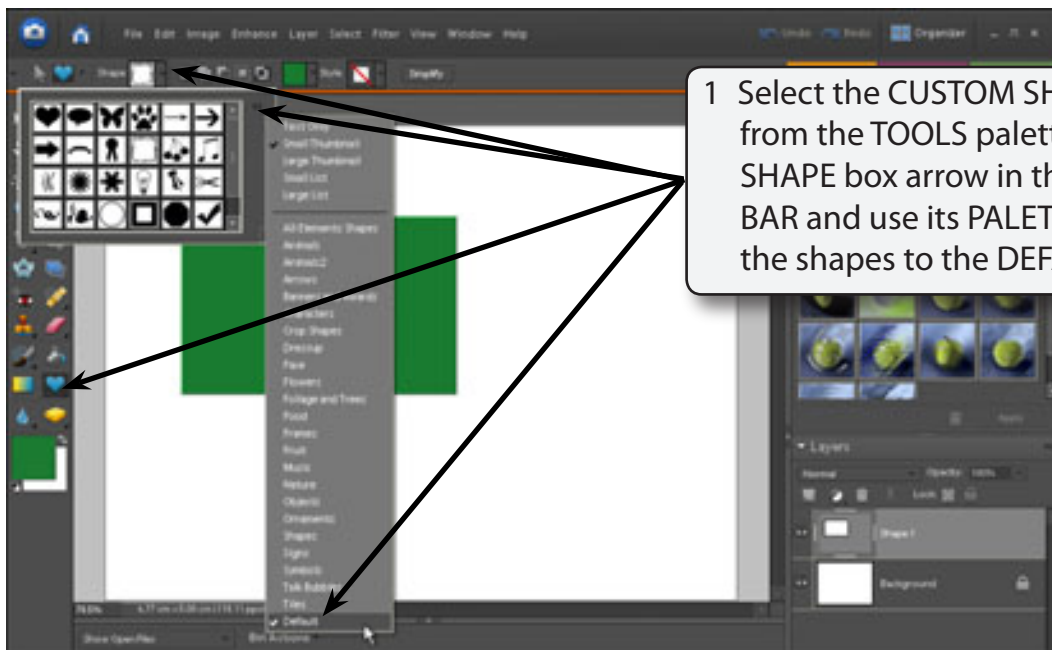

1 Select the CUSTOM SHAPE TOOL from the TOOLS palette. Click on the SHAPE box arrow in the OPTIONS BAR and use its PALETTE MENU to set the shapes to the DEFAULT shapes.

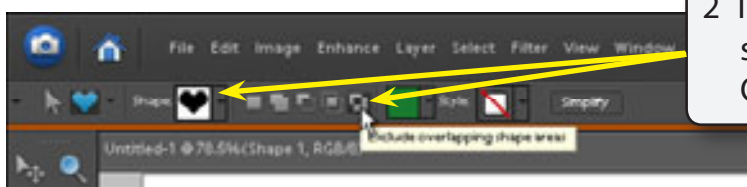

2 In the OPTIONS BAR select a shape and click on the EXCLUDE OVERLAPPING SHAPE AREAS button.

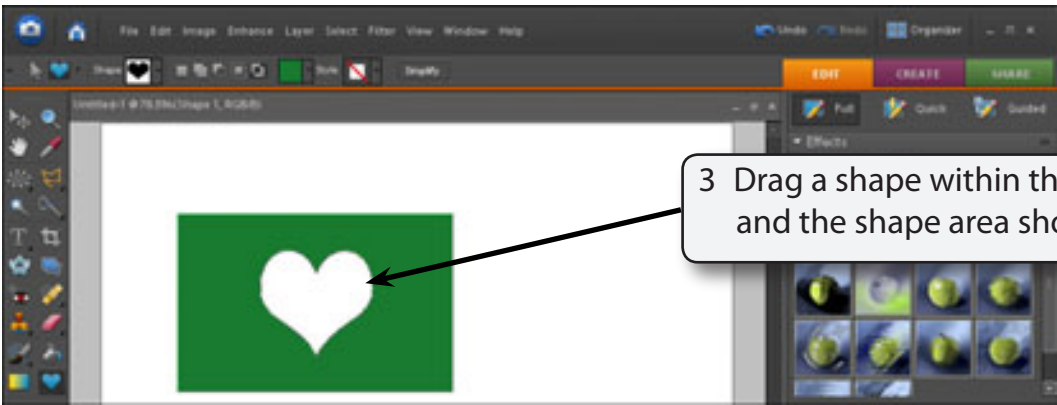

3 Drag a shape within the rectangle and the shape area should be white.

NOTE: The custom shape is white as that is the background colour and the shape has cut a hole in the rectangle. So you are seeing the background through the shape.

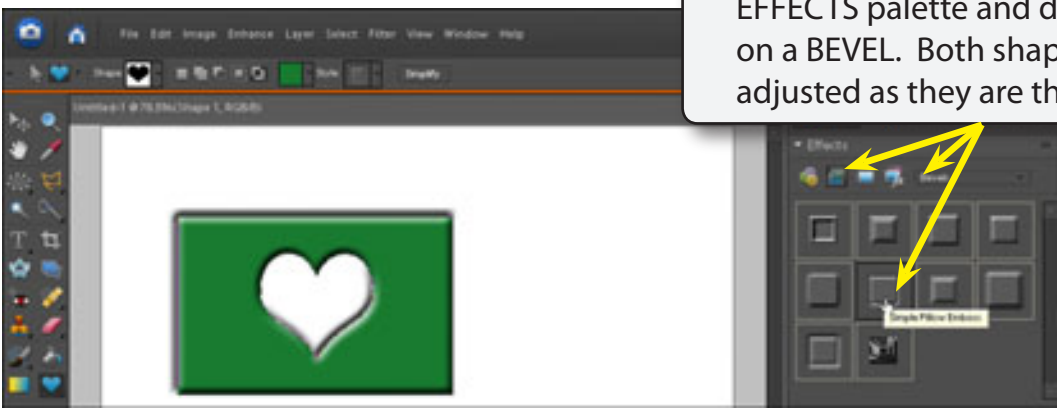

4 Click on the LAYER STYLE icon in the EFFECTS palette and double click on a BEVEL. Both shapes will be adjusted as they are the one shape.

C Adding Shapes to Shapes

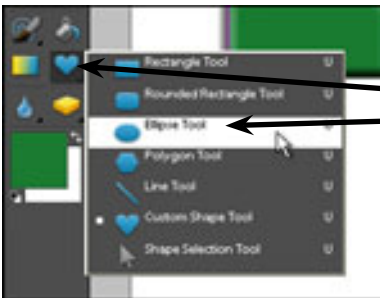

1 Select the ELLIPSE TOOL from the SHAPES TOOL in the TOOLS palette.

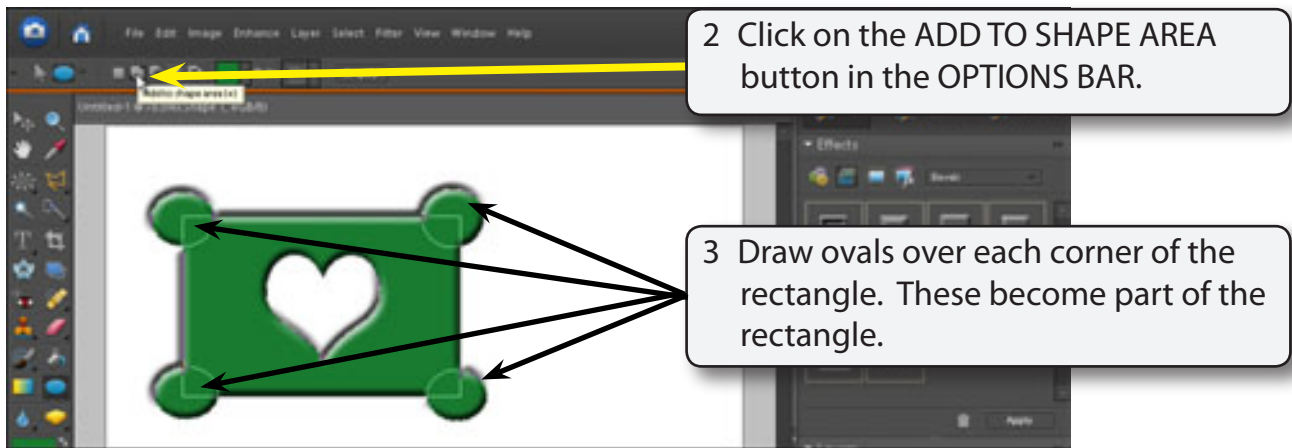

NOTE:

- i The ADD TO SHAPE AREA option causes the new shape to be combined with the previous shape.
- ii If you make a mistake when adding the ovals, press CTRL+Z or COMMAND+Z to undo the step and try again.

D Subtracting From the Shape

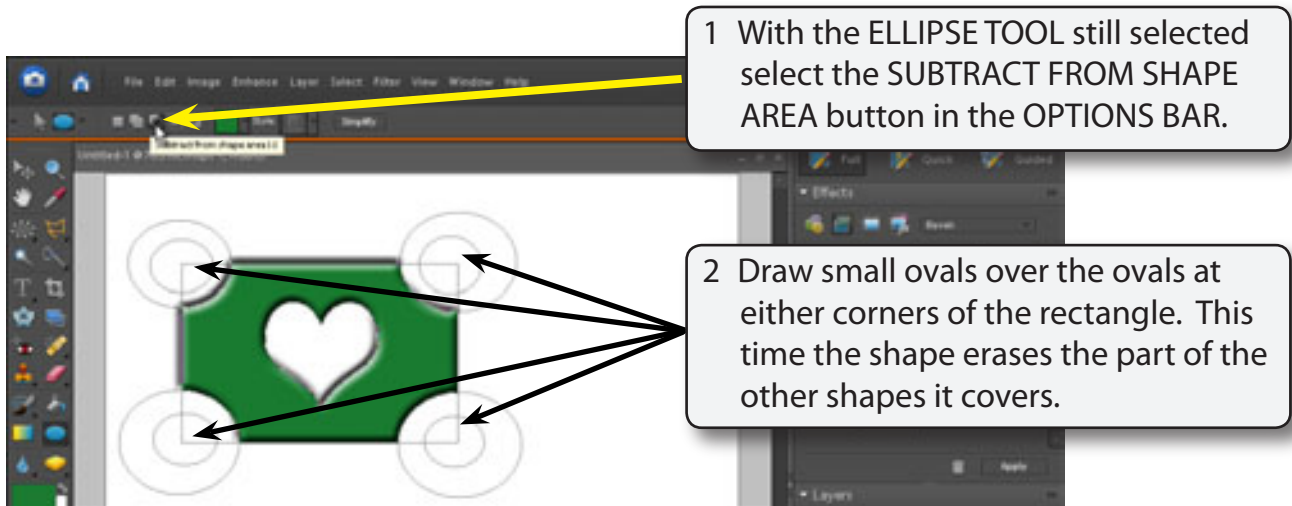

E Intersecting Shapes

You can draw a shape over another shape so that just the intersection between the two shapes is displayed.

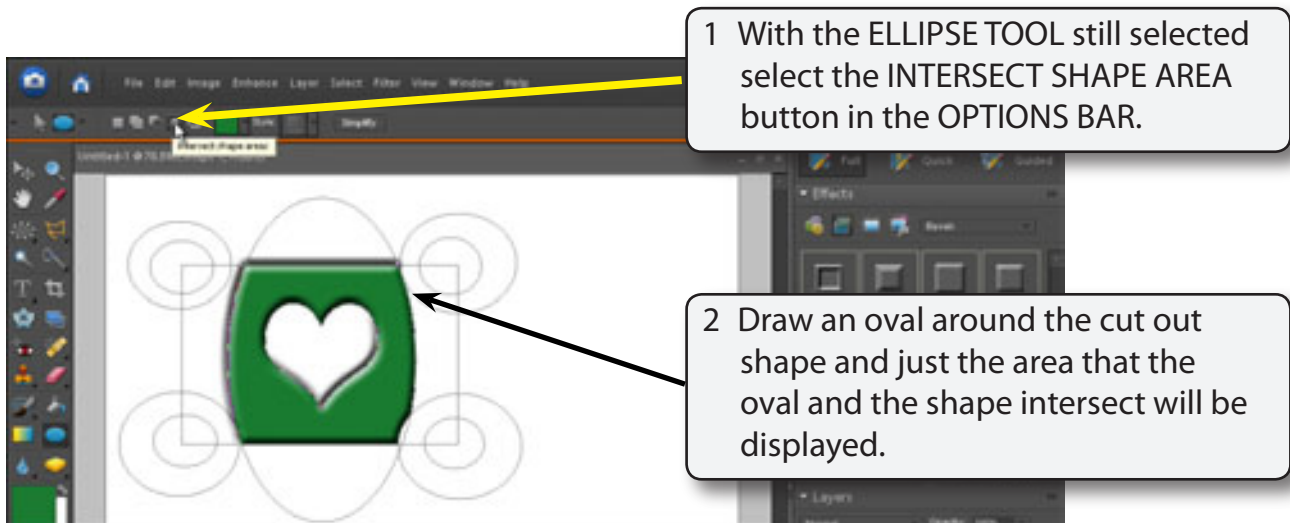

- 3 You can erase the outlines of the combined shapes so that just the remaining shape is displayed.

