

The Drawing Tools

Photoshop provides drawing tools that can be used with photos or in the creation of your own designs. These tools allow you to create web page buttons,, borders for photos, company logos, designs for T-shirt iron-on transfers, etc.

Starting a Blank Document

- 1 Load Photoshop Elements or close the current file.
- 2 Display the FILE menu, highlight NEW and select BLANK FILE.

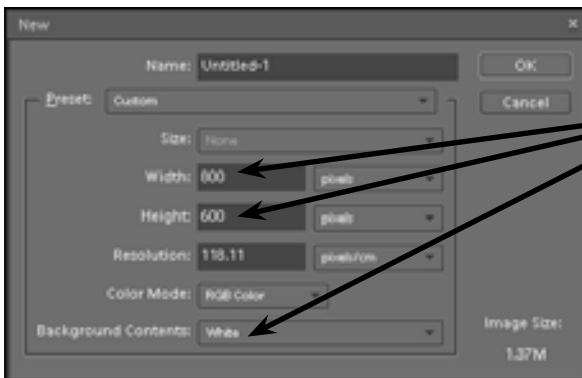

3 Set the WIDTH to 800 pixels, the HEIGHT to 600 pixels and the BACKGROUND CONTENTS to WHITE.

- 4 Select OK to start the document.

Drawing Normal Shapes

Photoshop provides the normal drawing shapes such as rectangles, ellipses, polygons and lines.

A Drawing Rectangles

- 1 The SHAPES TOOL is at the lower section of the TOOLS palette. It may contain a rectangle, ellipse, line or custom shape depending on which tool was used last.

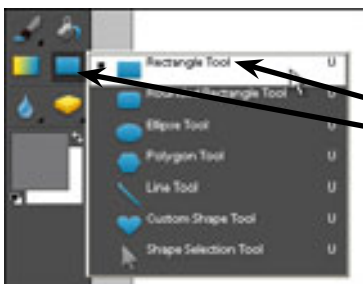

2 Click and hold the mouse button on the SHAPES TOOL in the TOOLS palette and select the RECTANGLE TOOL from the pop-up list of tools.

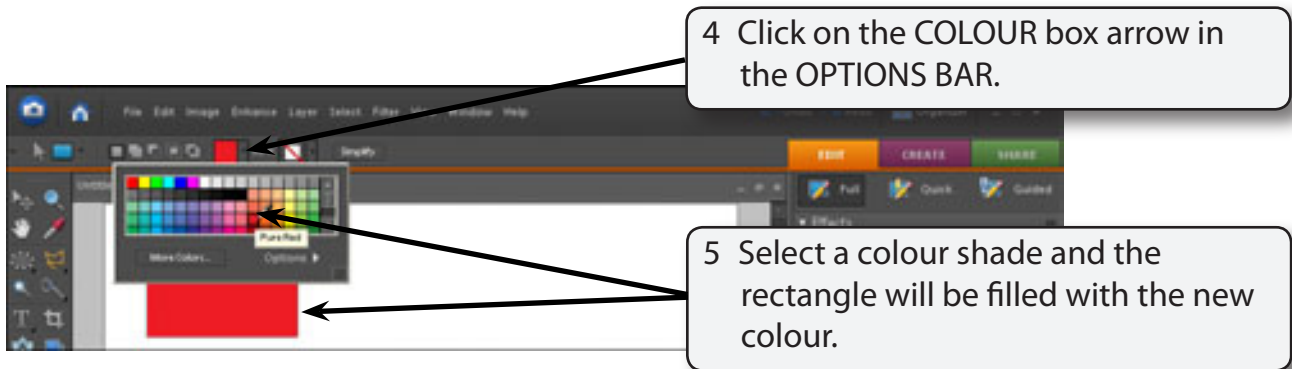
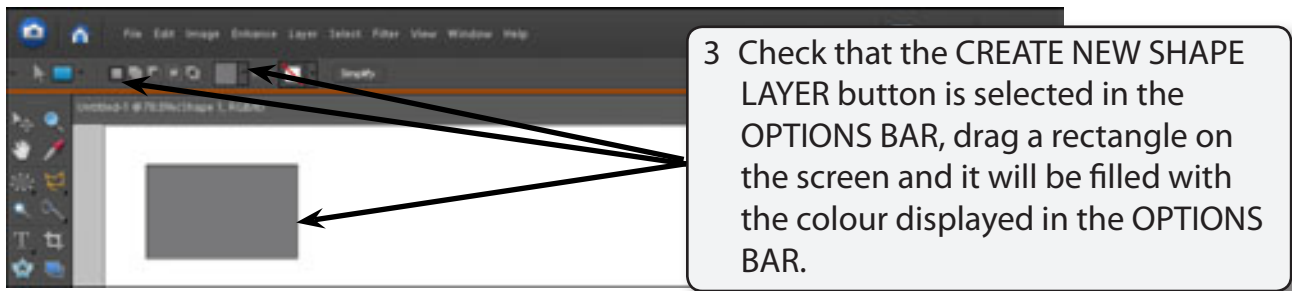

6 Click on the COLOUR box arrow again to close the COLOUR palette.

B Rectangle Styles

There are numerous styles that can be applied to a shape.

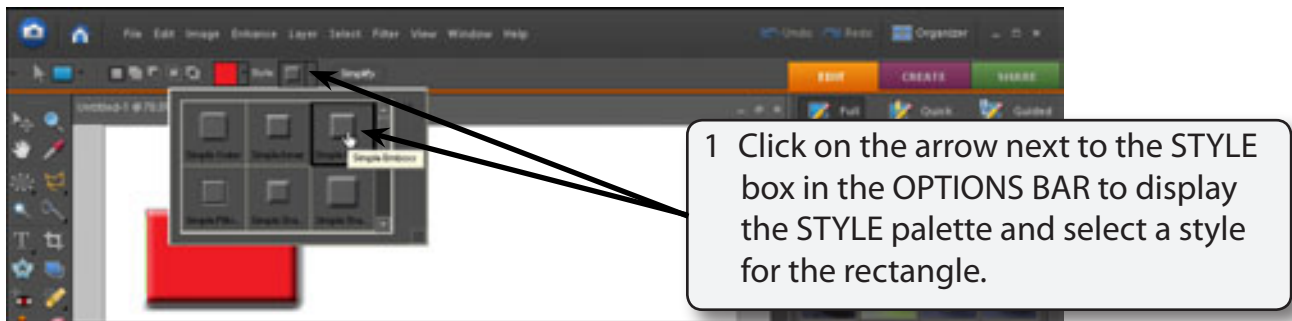

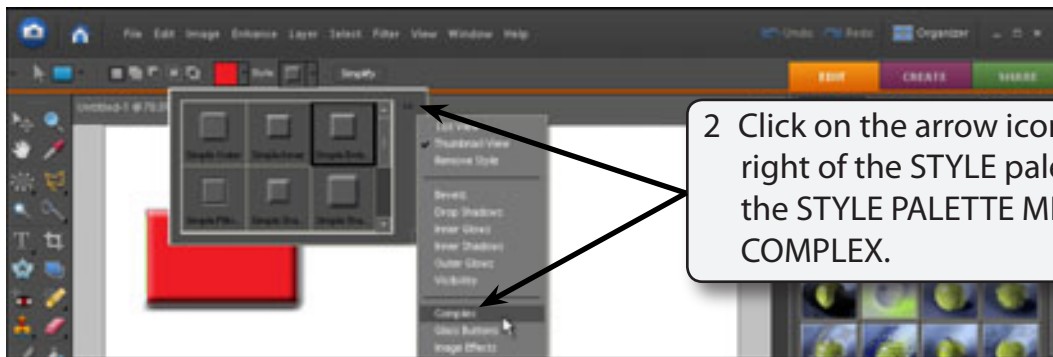

2 Click on the arrow icon at the top right of the STYLE palette to display the STYLE PALETTE MENU and select COMPLEX.

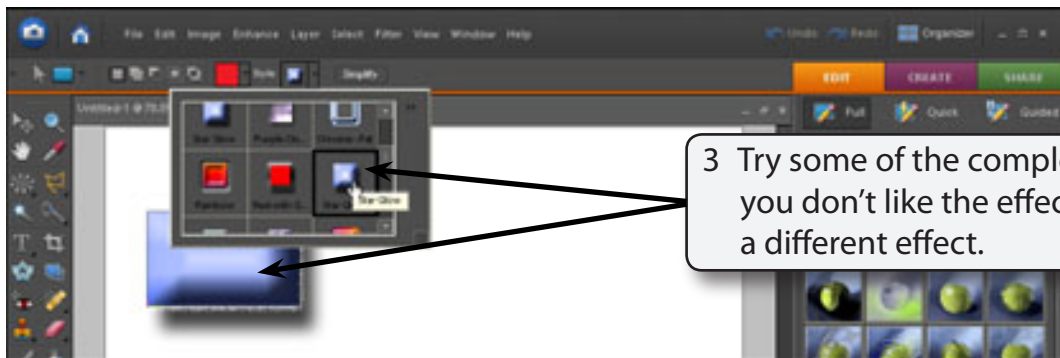

3 Try some of the complex styles. If you don't like the effect simply select a different effect.

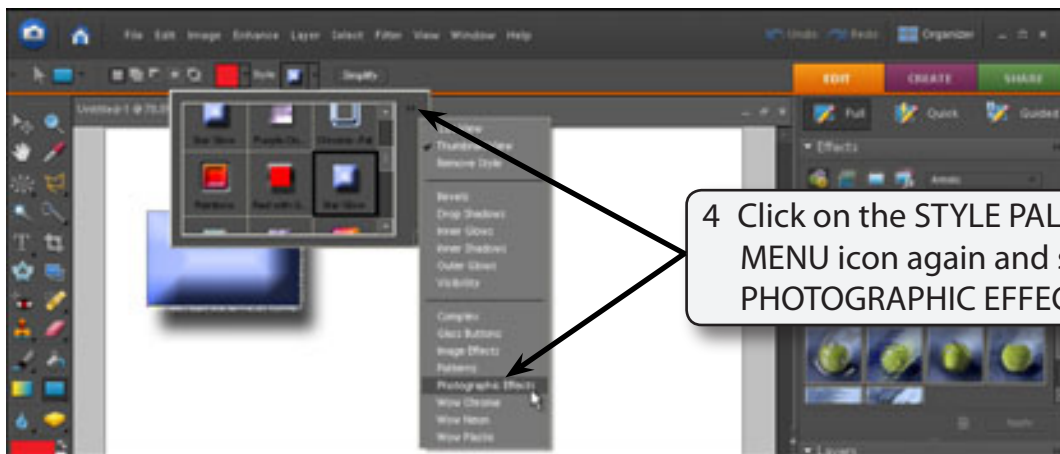

4 Click on the STYLE PALETTE MENU icon again and select PHOTOGRAPHIC EFFECTS.

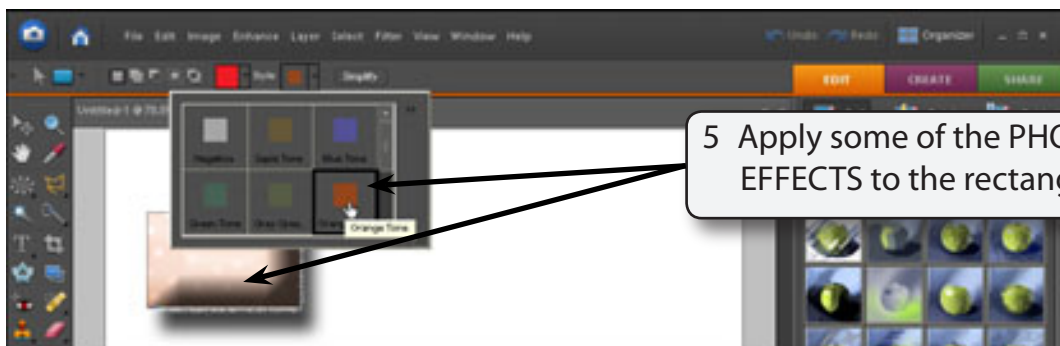

5 Apply some of the PHOTOGRAPHIC EFFECTS to the rectangle.

- 6 Try some other styles from the STYLE PALETTE MENU. Some are suitable for rectangles others are less effective.

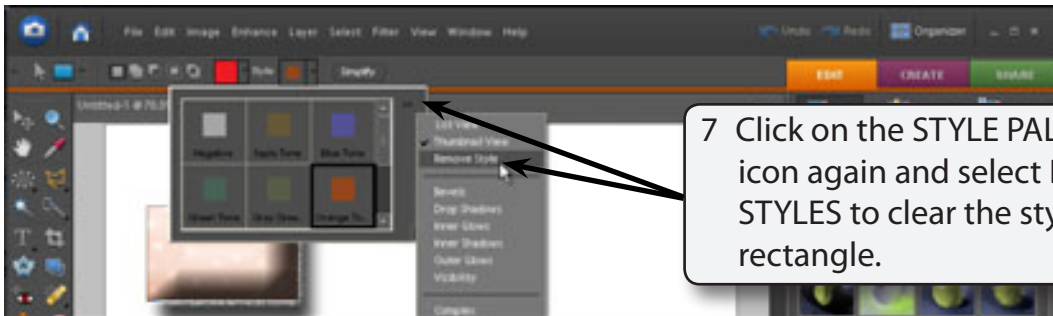

C Using the Effects Palette

You can also apply styles to the rectangle from the EFFECTS palette.

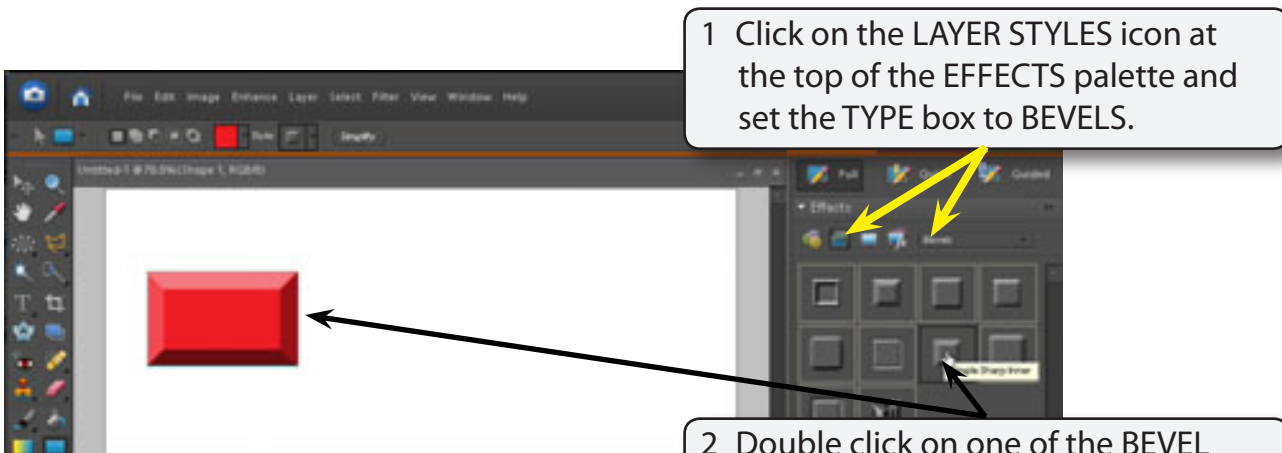

- 2 Double click on one of the BEVEL styles to apply it to the rectangle

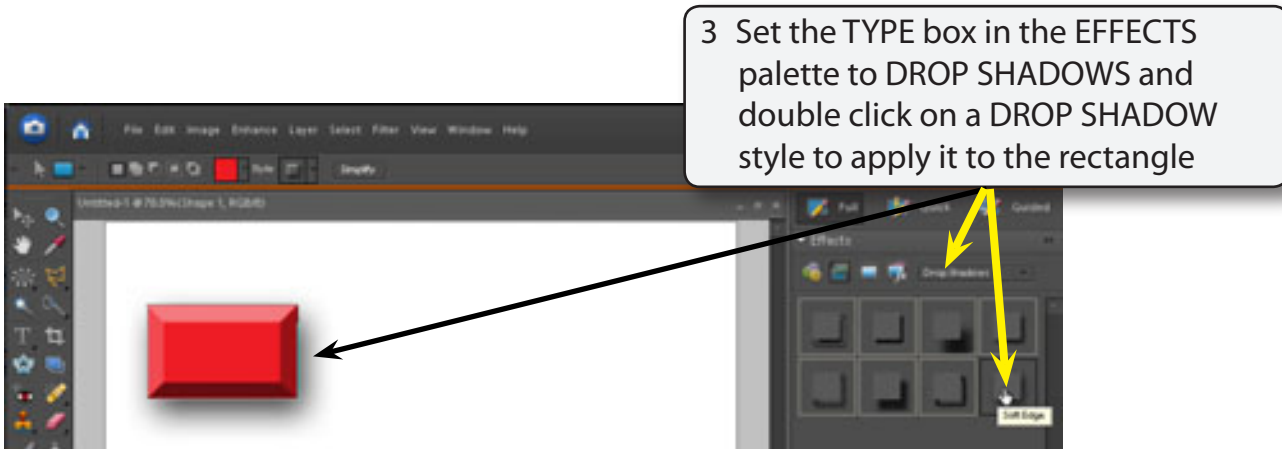

- 3 Set the TYPE box in the EFFECTS palette to DROP SHADOWS and double click on a DROP SHADOW style to apply it to the rectangle

D Creating Buttons

Buttons have become a vital part of web sites. Photoshop Elements allows you to quickly produce professional looking buttons.

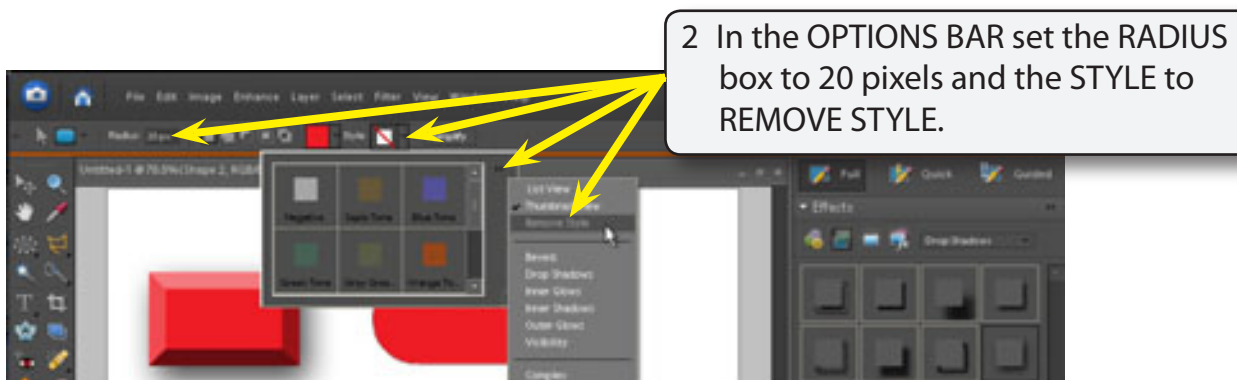
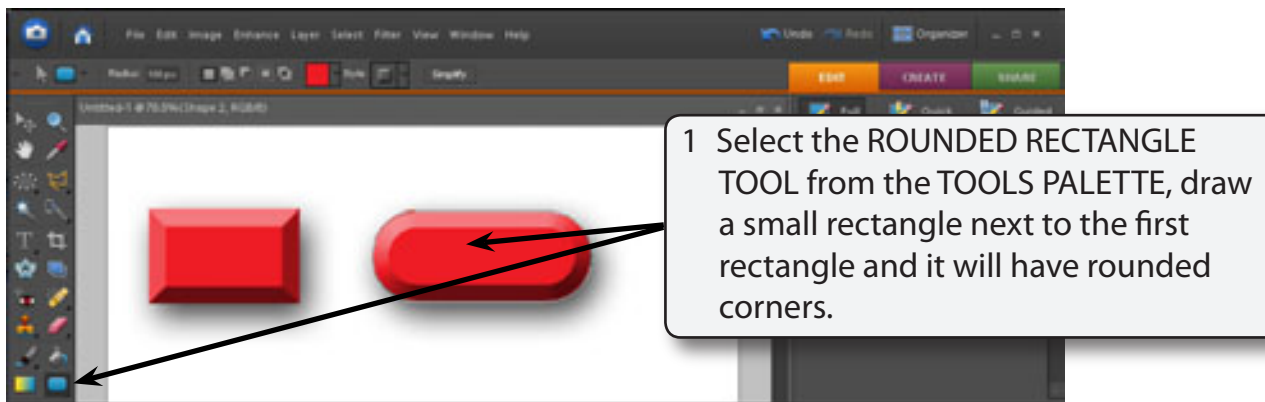

- NOTE:**
- i The **RADIUS** box controls the size of the rounded corners of the rectangle.
 - ii Notice that there are now 3 layers in the **LAYERS** palette. One for the background and layers for each shape.

3 When you make a style change only the shape in the selected layer is altered.