

# Working With Perspective

Photos are 2-dimensional images usually of 3-dimensional objects or scenes. When a photo is taken with a camera there is often some perspective errors due to horizontal or vertical camera tilt. Photoshop provides a range of tools that try to repair these errors whilst retaining the perspective of the image.

## Straightening an Image

When you simply want to straighten an image, the RULER TOOL can be used. The RULER TOOL measures the angle of tilt in a photo.

### A Loading the Sample Photo

- 1 Load Photoshop or close the current file and select OPEN from the FILE menu.
- 2 Access the PSCs5 SUPPORT FILES, open the CHAPTER 22 folder and open the file:

Big Ben

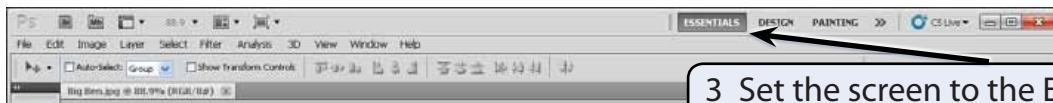

3 Set the screen to the ESSENTIALS workspace.

- 4 Press CTRL+0 or COMMAND+0 to set the view to FIT ON SCREEN.

### B Applying the Ruler Tool



1 Notice that BIG BEN is on a slight angle and should be vertical.

2 Select the RULER TOOL from the TOOLS panel - it is within the EYEDROPPER TOOL.

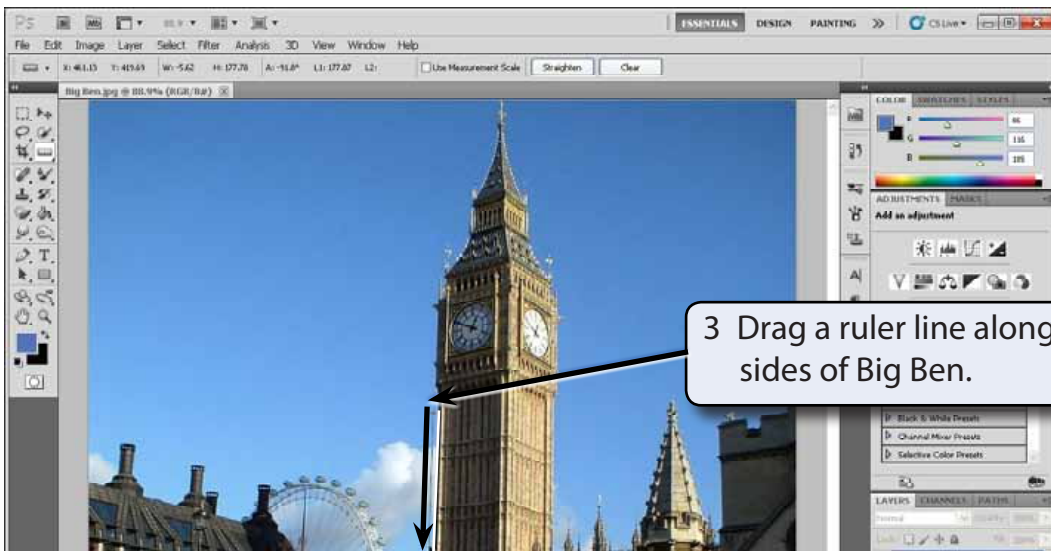

3 Drag a ruler line along one of the sides of Big Ben.

4 Display the IMAGE menu, highlight IMAGE ROTATION and select ARBITRARY.



5 The angle of tilt is measured and displayed in the ANGLE box.

6 Leave °CCW (counter clockwise) selected, which is the direction to straighten the image and select OK.

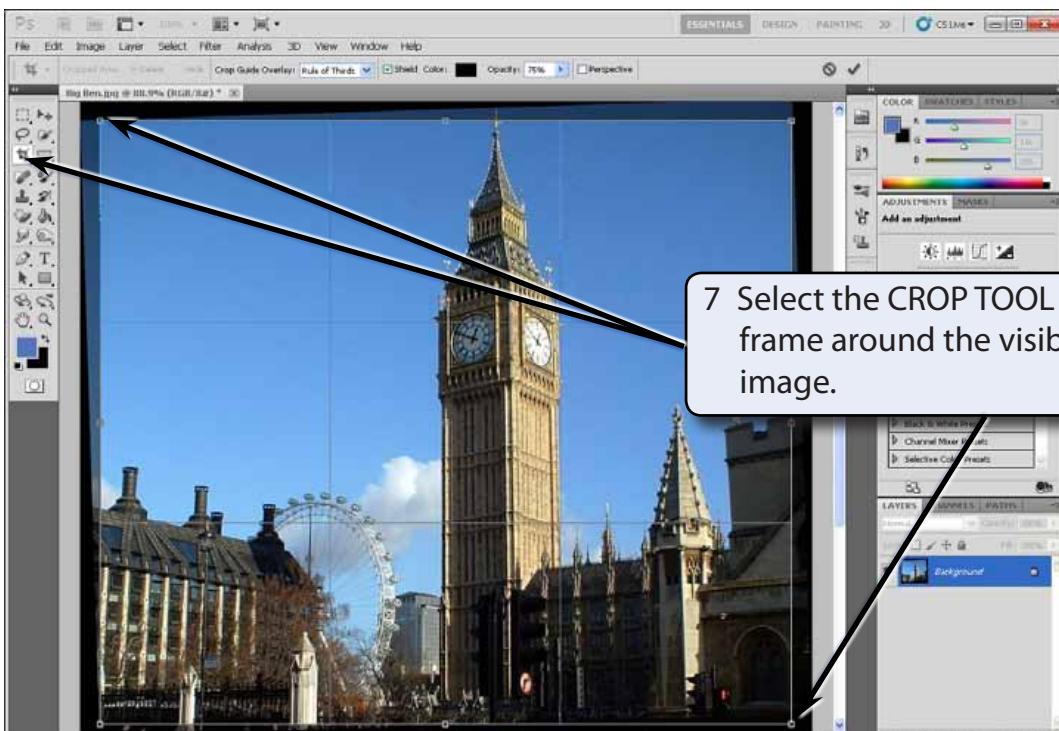

7 Select the CROP TOOL and drag a frame around the visible parts of the image.

**NOTE:** You can use the handles to adjust the crop frame so that just parts of the image are selected.

- 8 Double click inside the crop frame to complete the crop.
- 9 Save the image in your STORAGE folder if you wish.

## Lens Correction

The LENS CORRECTION filter can be used to minimize distortions created by incorrect camera angles. You can also create some interesting effects with this filter.

### A Loading the Sample Photo

- 1 Close the Big Ben file and select OPEN from the FILE menu.
- 2 Access the PScs5 SUPPORT FILES, open the CHAPTER 22 folder and open the file:  
Cathedral

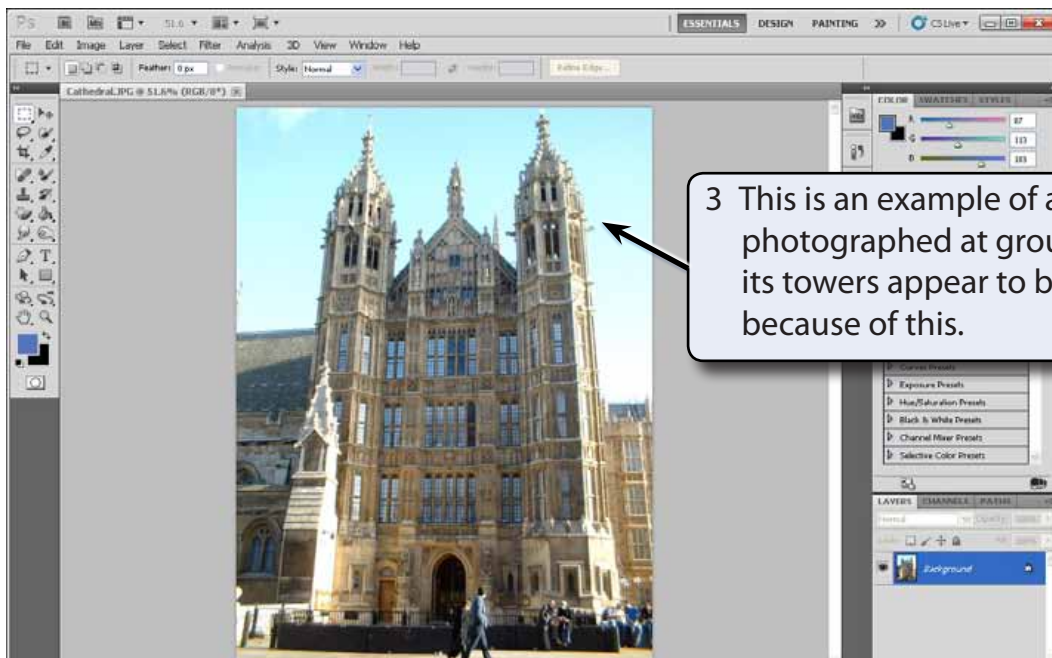

- 4 The LENS CORRECTION filter can be used to reduce this effect.

## B Applying the Lens Correction Filter

- 1 Display the FILTER menu and select LENS CORRECTION to open the LENS CORRECTION dialogue box.

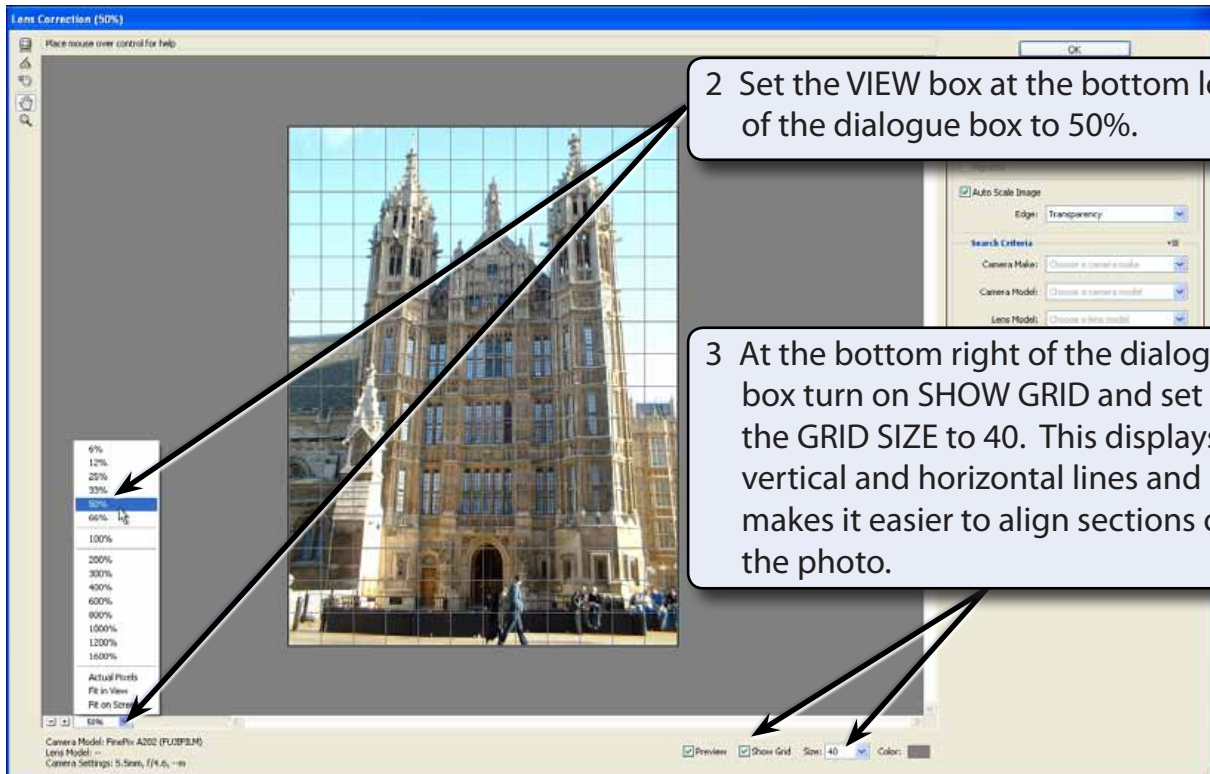

**NOTE:** The LENS CORRECTION tools are at the right of the dialogue box in two separate tabs

## C Adjusting the Vertical Perspective

The main problem with this photo is in the vertical direction.

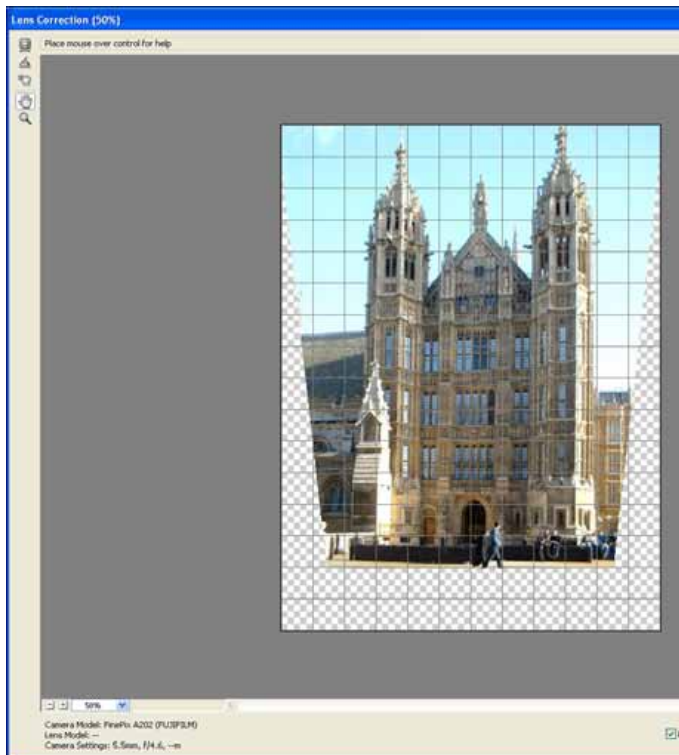

1 Click on the CUSTOM tab at the top right of the dialogue box.



2 Drag the VERTICAL PERSPECTIVE slider to about -45 then set the SCALE to 75%. The towers of the cathedral should be close to vertical.

**NOTE:** The HORIZONTAL PERSPECTIVE slider can be used to make horizontal objects parallel.

3 Select OK to accept the adjustment.