

The History Panel and History Brush

The HISTORY panel is a valuable asset in the development of a product. It records the steps that you carry out in a session. Each step is called a STATE. You can return to states, save a snapshot at a certain position, save a file at a certain position and so forth.

Using the History Panel

To demonstrate how to use the HISTORY panel, a photo will be opened, some edits made to it then the HISTORY panel used to manage those edits.

A Loading the Sample Photo

- 1 Load Photoshop or close the current files and select OPEN from the FILE menu.
- 2 Access the PScs4 SUPPORT FILES, open the CHAPTER 21 folder and open the file:
History
- 3 Check that the workspace is set to the ESSENTIALS workspace then display the WINDOW menu and select HISTORY to open the HISTORY panel.



4 The OPEN file step has been added to the HISTORY panel.

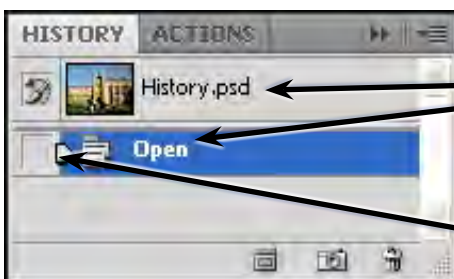

5 The panel has two areas, the SNAPSHOT area at the top and the STATES area below it.

6 The ARROW marker is used to select STATES.

B Altering the Photo

Some edits will be made to the photo so that you can see how the HISTORY panel records them.

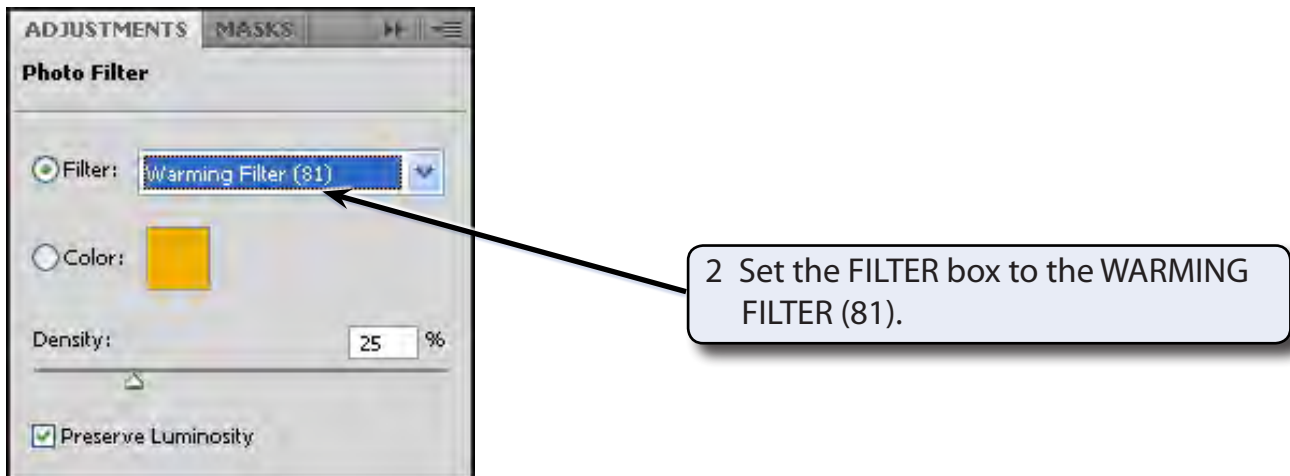
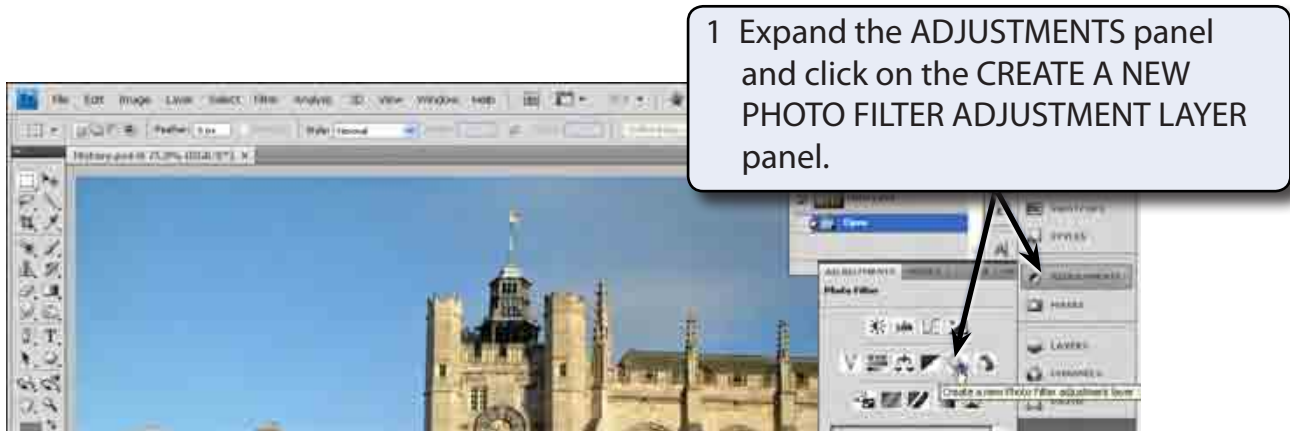

NOTE: The PHOTO FILTERS are similar to filters on a camera to adjust the photo for different light.



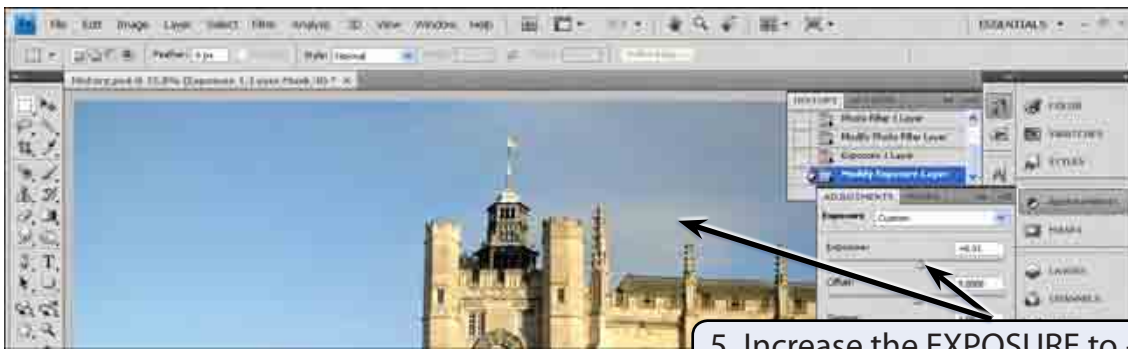

5 Increase the EXPOSURE to +0.30 and the image will become lighter.



6 Select the BRUSH TOOL, select a SOFT ROUND 45 PIXEL brush size and paint over the sky 3 times. Each time you release the mouse button a BRUSH TOOL state is recorded in the HISTORY panel.

NOTE: The painting of the sky does not need to be too accurate as some of it will be deleted using the HISTORY panel shortly.

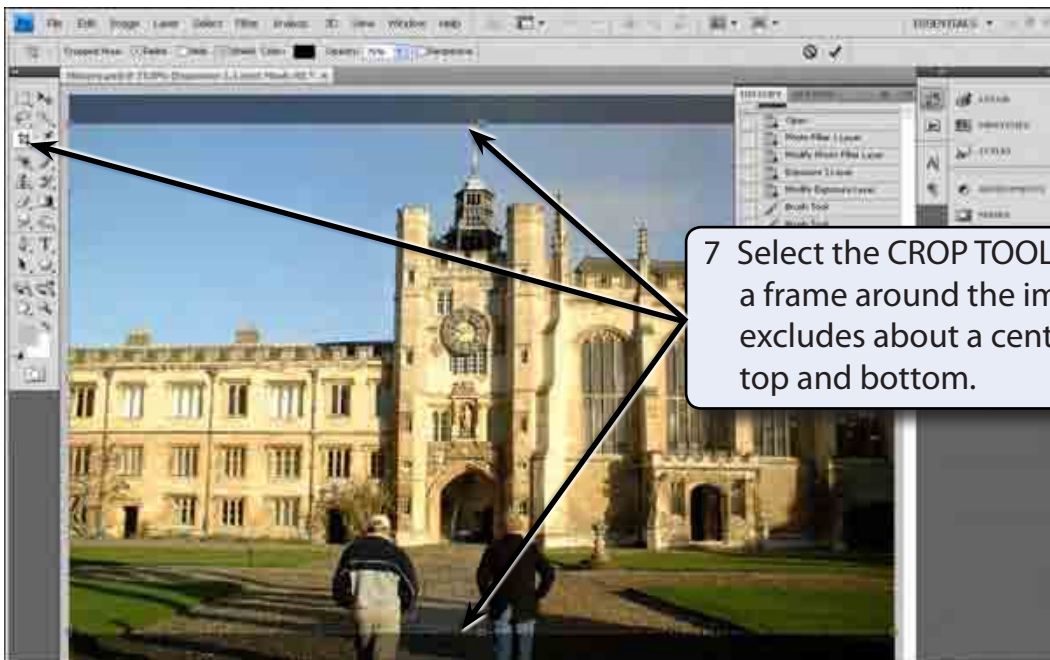

7 Select the CROP TOOL and drag a frame around the image that excludes about a centimetre at the top and bottom.



8 Double click inside the crop frame to complete the crop and the CROP state is added to the HISTORY panel.