

Applying Artistic Filters

You can use the filters that Photoshop provides to create artistic sketches. To illustrate this the following sketch of a shipwreck viewed through the porthole of another ship will be created. There are more applications of Photoshop like this in Module 3.



Starting a New Document

- 1 Load Photoshop or close the current files then display the FILE menu and select NEW.

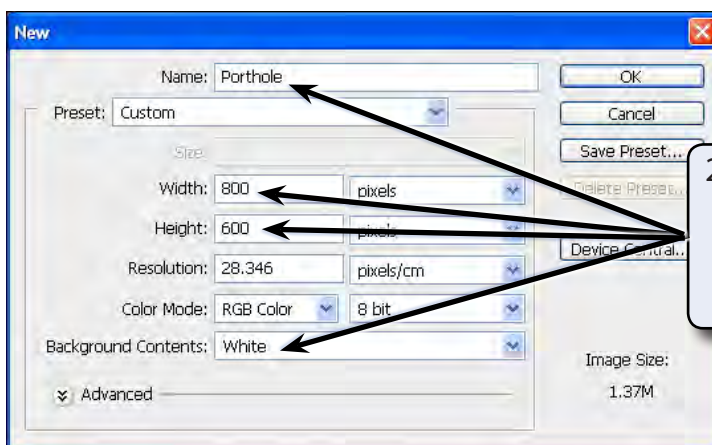

2 Set the NAME to PORTHOLE, the WIDTH to 800 pixels, the HEIGHT to 600 pixels and the BACKGROUND COLOUR to WHITE.

- 3 Select OK to start the document.

Setting the Background

The CLOUDS filter will be used to create the sky for the sketch.

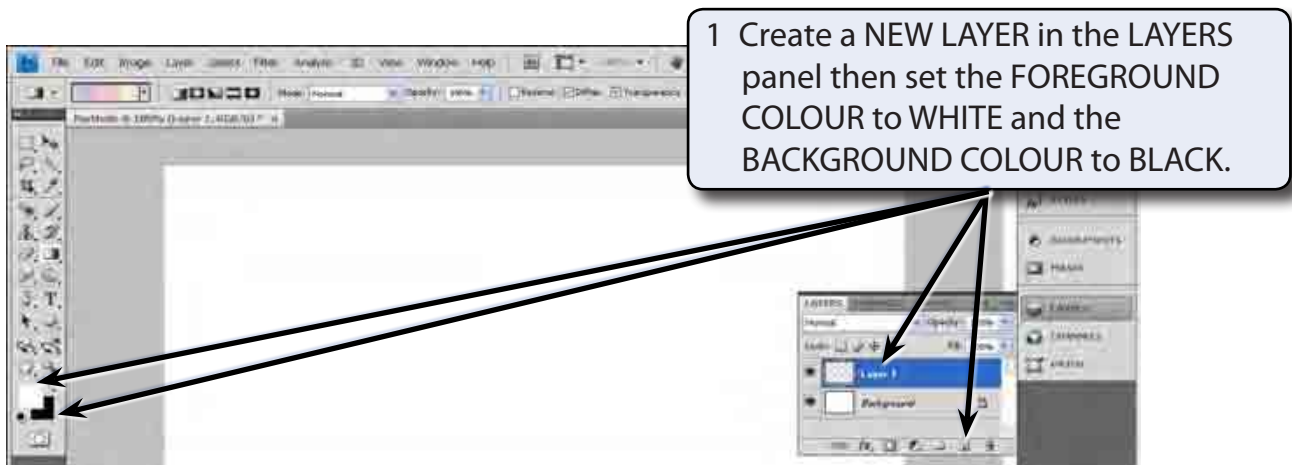

- 2 Display the FILTER menu, highlight RENDER and select CLOUDS to fill the layer with black and white clouds.
- 3 The clouds can be coloured to make them look more natural. Display the IMAGE menu, highlight ADJUSTMENTS and select HUE/SATURATION.

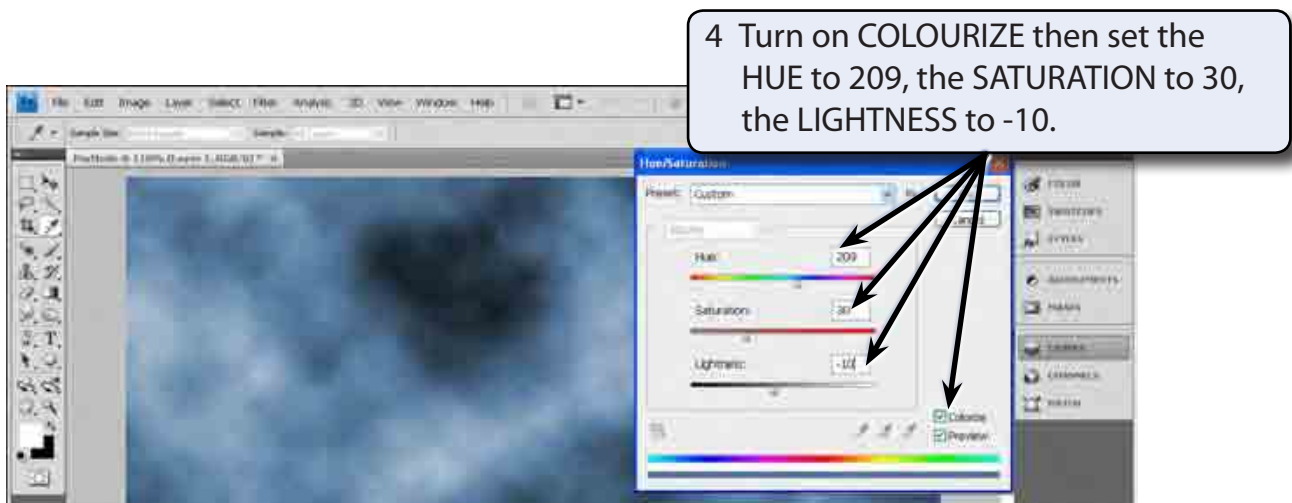

- 5 Select OK to colourise the clouds.

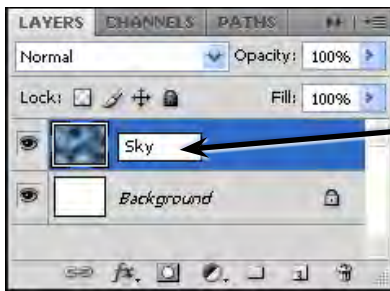

6 Rename the layer: Sky

Creating the Ocean

The ocean can be created by combining the CLOUDS and BAS RELIEF filters.

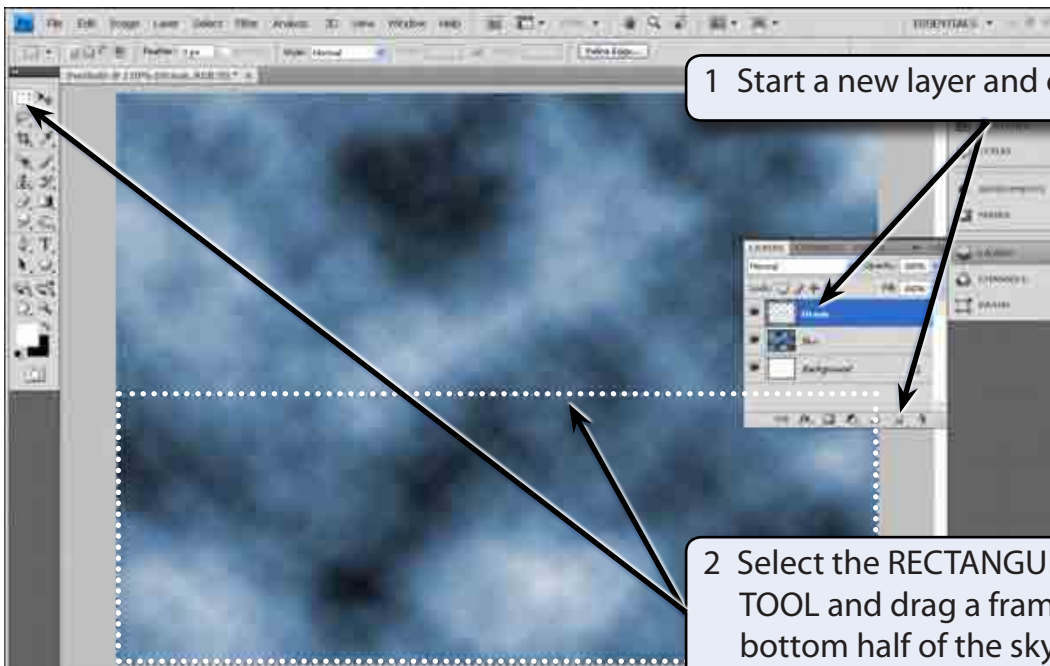

1 Start a new layer and call it: Ocean

2 Select the RECTANGULAR MARQUEE TOOL and drag a frame around the bottom half of the sky.

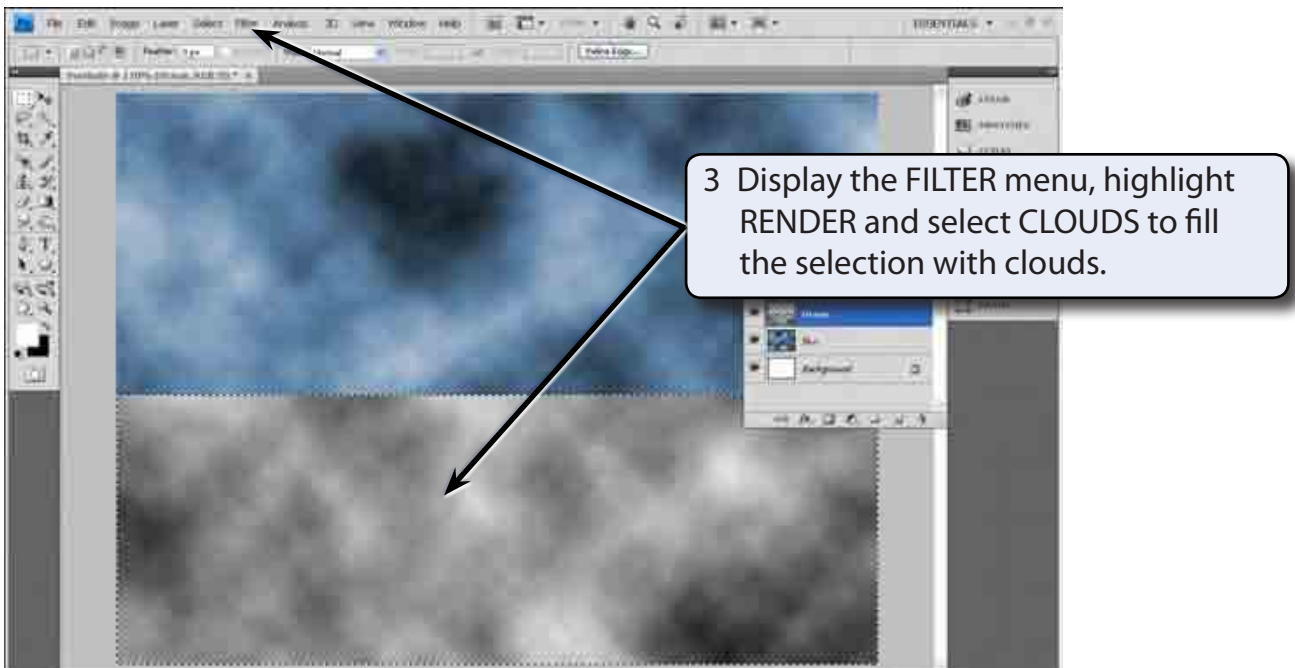

4 Display the FILTER menu again, highlight SKETCH and select BAS RELIEF.

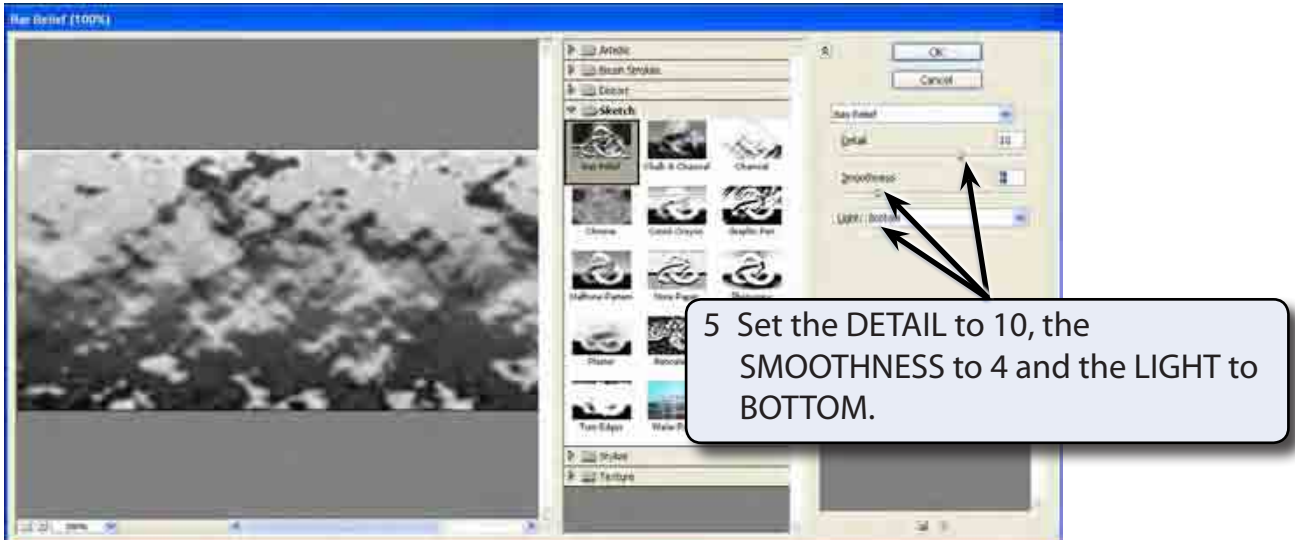

6 Select OK to set the filter.

7 The colour of the ocean needs to be adjusted. Display the IMAGE menu, highlight ADJUSTMENTS and select HUE/SATURATION.