

The Drawing Tools

Photoshop provides drawing tools that can be used with photos or in the creation of your own designs. These tools allow you to create web page buttons, designs for T-shirt iron-on transfers, borders for photos, company logos, etc.

Starting a Blank Document

- 1 Load Photoshop or close the current file.
- 2 Display the FILE menu and select NEW.

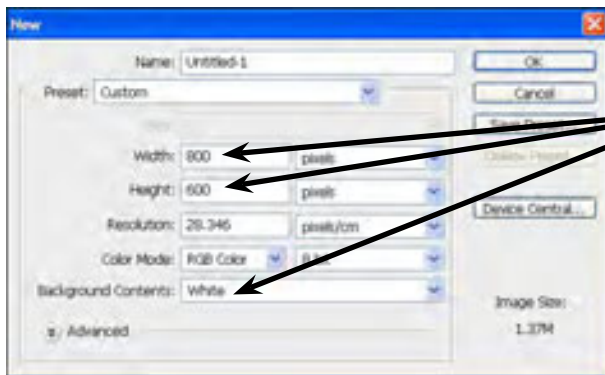

3 Set the WIDTH to 800 pixels, the HEIGHT to 600 pixels and the BACKGROUND CONTENTS to WHITE.

- 4 Select OK to start the document.

Drawing Normal Shapes

Photoshop provides the normal drawing shapes such as rectangles, ellipses, polygons and lines.

A Drawing Rectangles

- 1 The SHAPES TOOL is at the lower section of the TOOLS palette. It may contain a rectangle, ellipse, line or custom shape depending on which tool was used last.

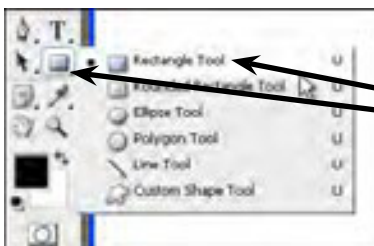

2 Click and hold the mouse button on the SHAPES TOOL in the TOOLS palette and select the RECTANGLE TOOL from the pop-up list of tools.

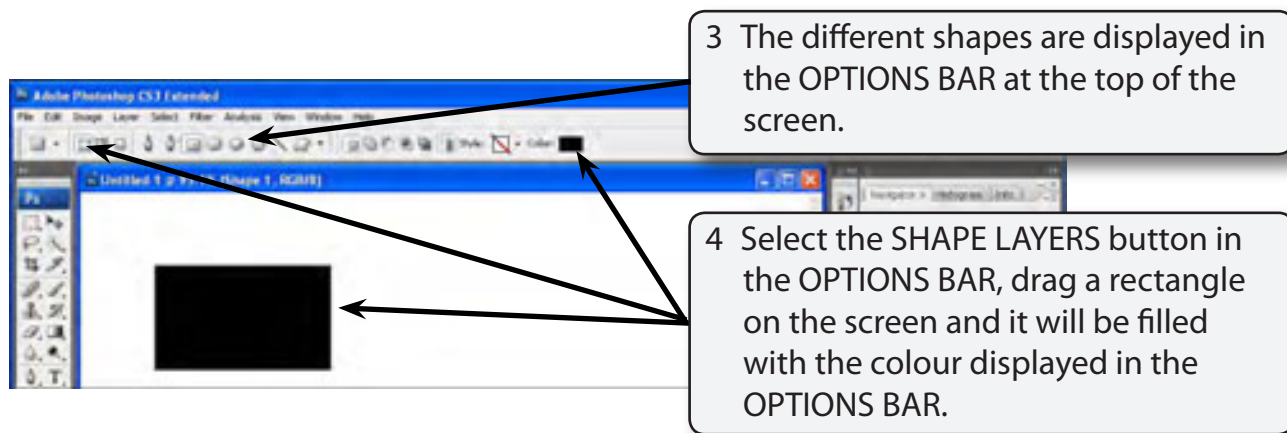

5 Click on the COLOUR button in the OPTIONS BAR.

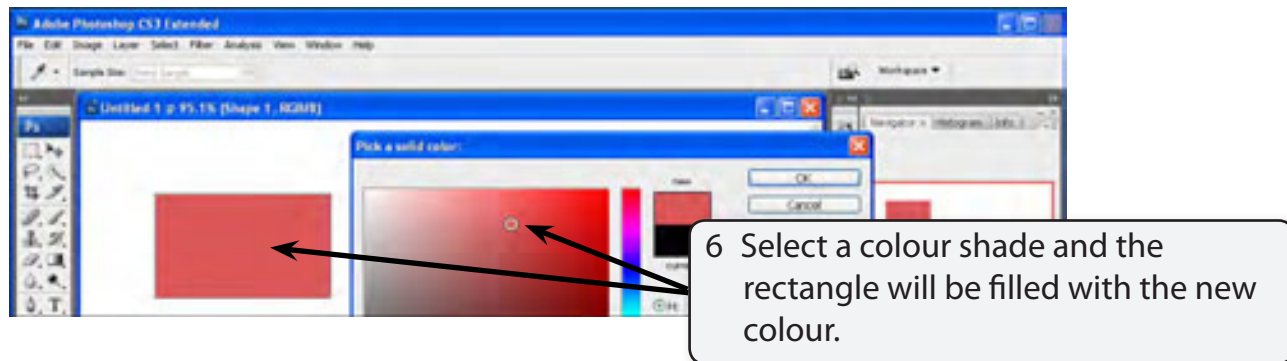

7 Select OK to accept the new colour.

B Rectangle Styles

There are numerous styles that can be applied to a shape.

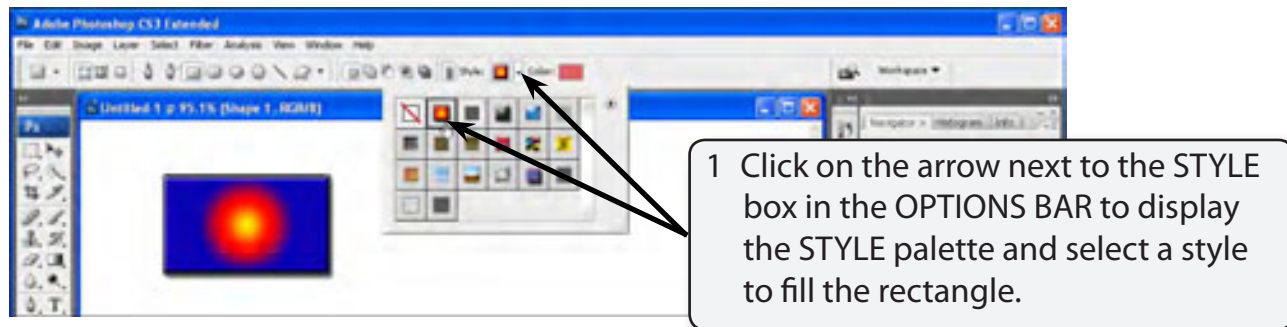

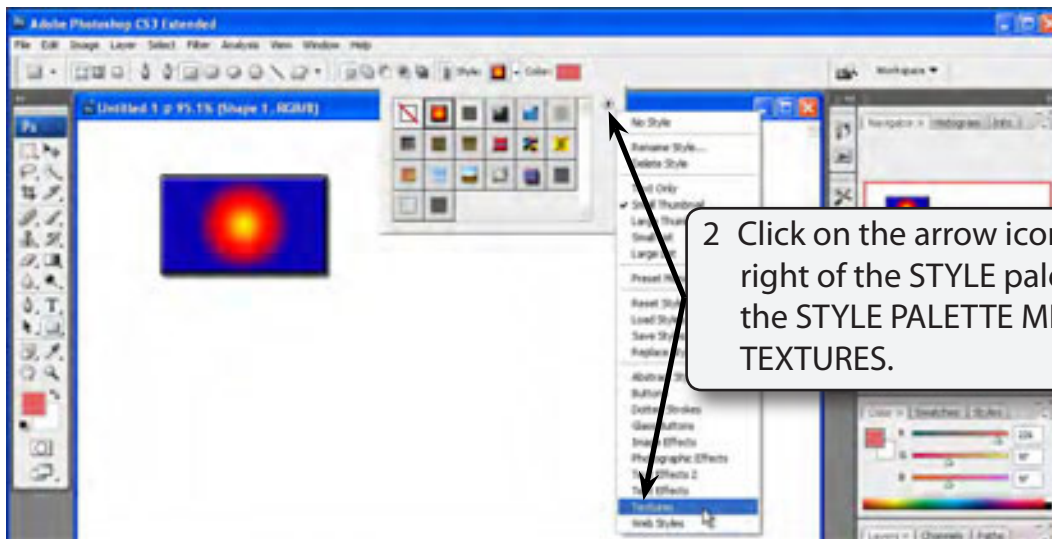

2 Click on the arrow icon at the top right of the STYLE palette to display the STYLE PALETTE MENU and select TEXTURES.

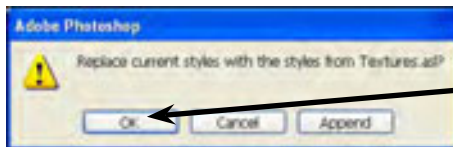

3 Select OK to replace the current styles with the TEXTURES styles.

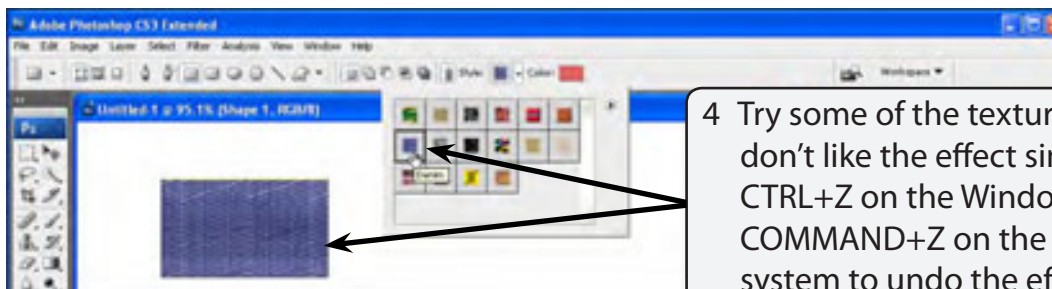

4 Try some of the textures. If you don't like the effect simply press CTRL+Z on the Windows system or COMMAND+Z on the Macintosh system to undo the effect.

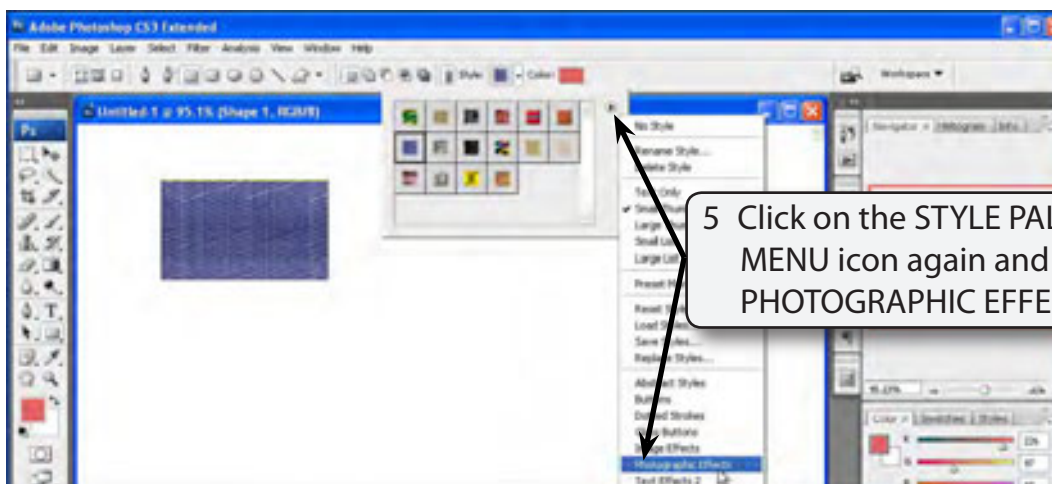

5 Click on the STYLE PALETTE MENU icon again and select PHOTOGRAPHIC EFFECTS.



6 Select OK to replace the TEXTURES styles with the PHOTOGRAPHIC EFFECTS styles.

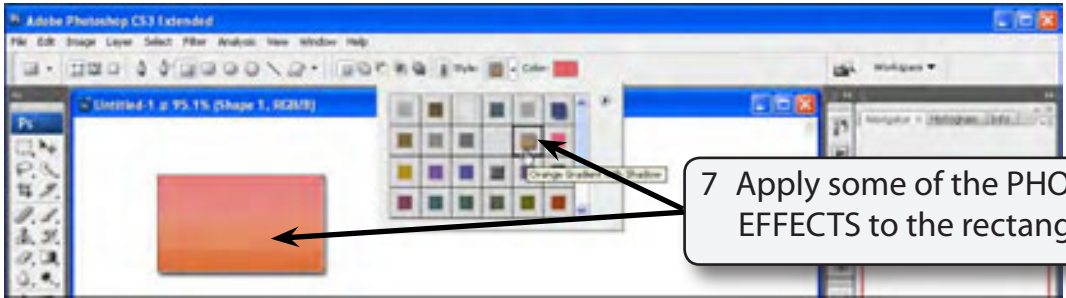

7 Apply some of the PHOTOGRAPHIC EFFECTS to the rectangle.

8 Try some other styles from the STYLE PALETTE MENU. Some are suitable for rectangles others are less effective.

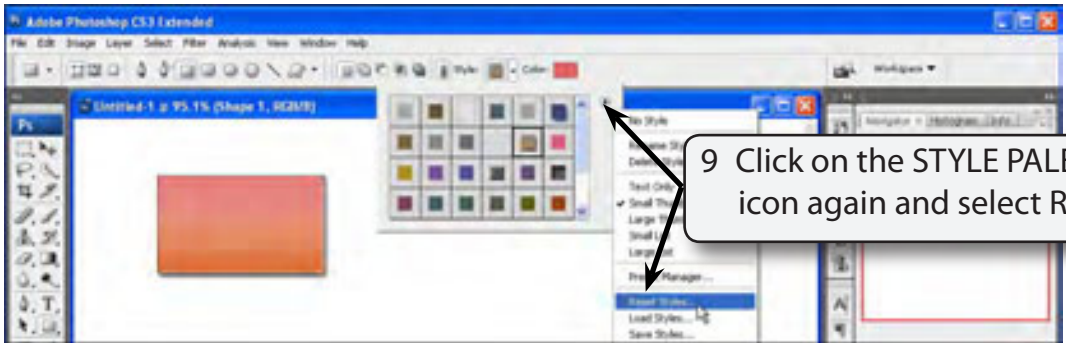

9 Click on the STYLE PALETTE MENU icon again and select RESET STYLES.

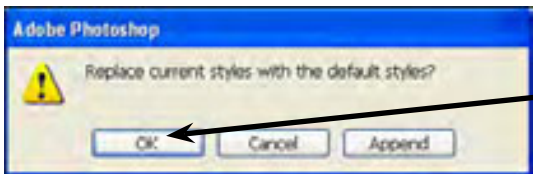

10 Select OK to return the styles to the DEFAULT STYLES.

NOTE: These styles can also be applied from the STYLES palette as you did in the last chapter.

C Creating Buttons

Buttons have become a vital part of web sites. Photoshop allows you to quickly produce professional looking buttons.

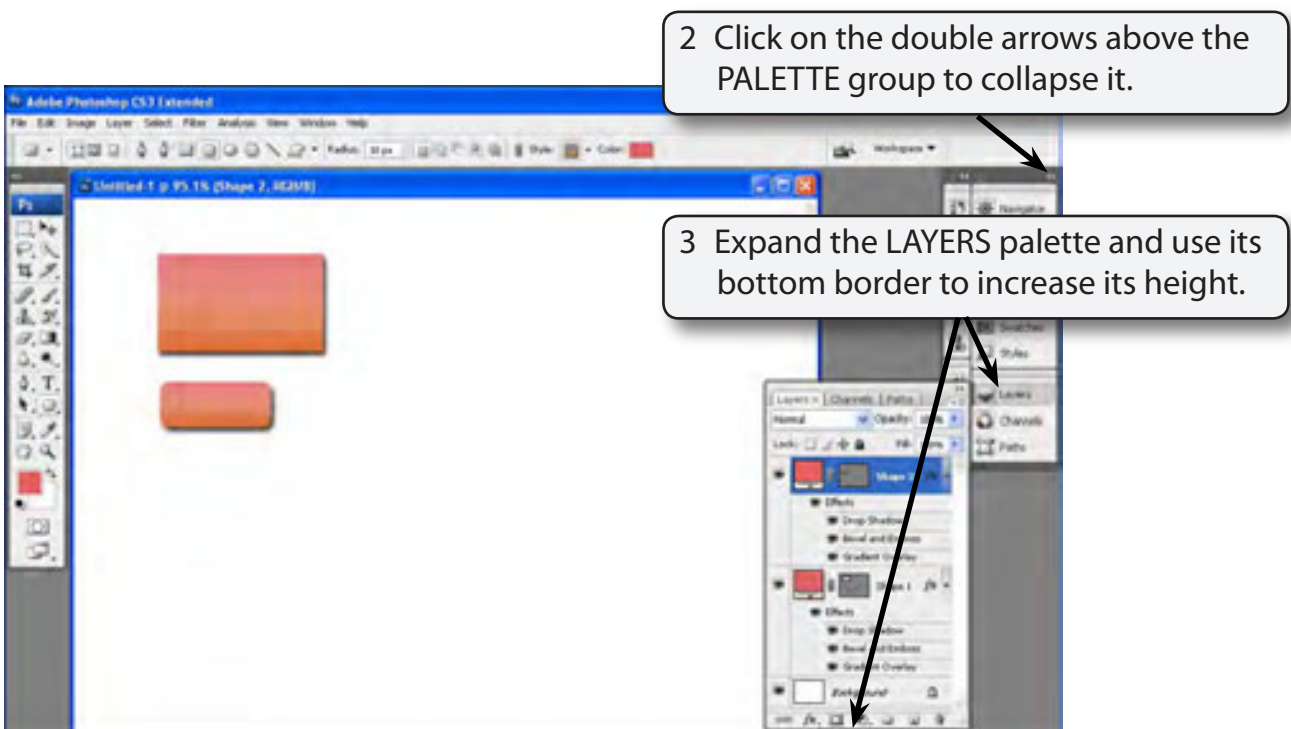
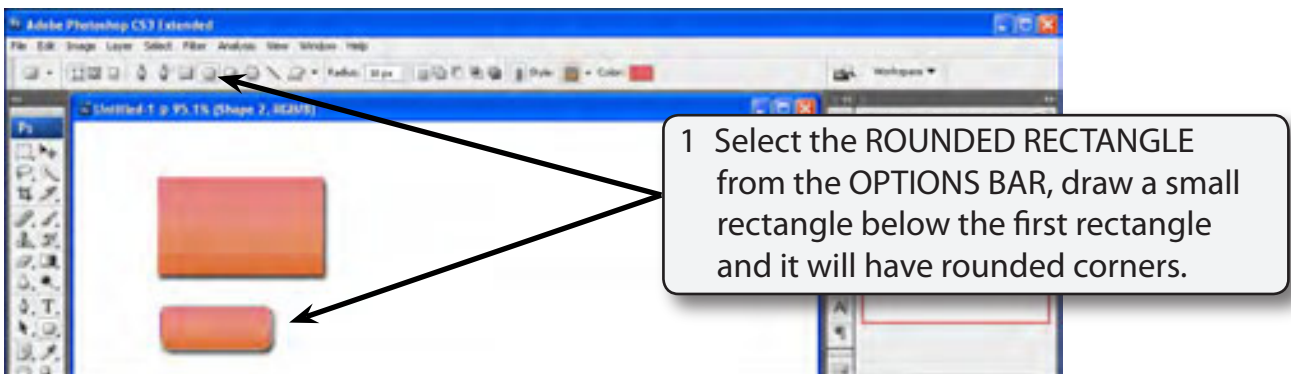

- NOTE:**
- i When adding effects to shapes it is handy to see more of the contents of the **LAYERS** palette by having just it expanded.
 - ii Notice that there 3 layers in the **LAYERS** palette. One for the background and layers for each shape.