

Three Dimensional Boxes

Three dimensional boxes can be easily produced in Photoshop. Let's say that you have been contracted by the software producer, ArtSoft, to produce an image of the box for their recently released graphics program, Splosh Strokes, so that it can be placed on their web site. The following image will be produced:

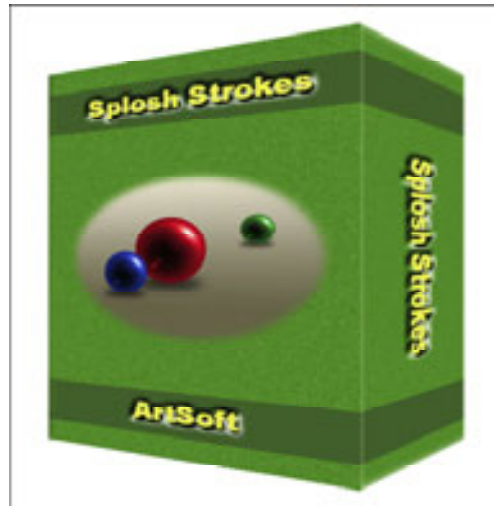

Starting a New Document

- 1 Load Photoshop, display the FILE menu and select NEW.

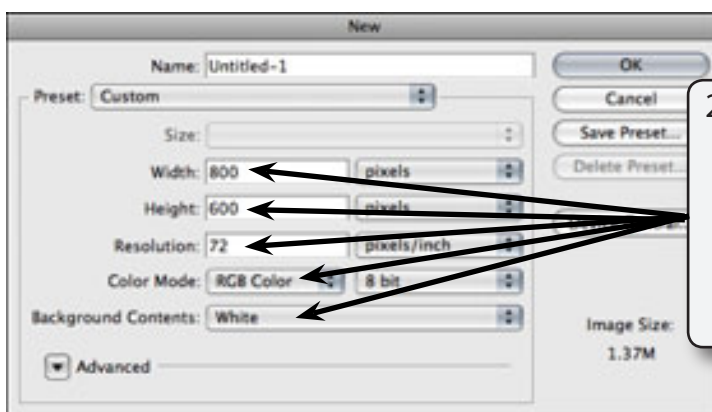

- 2 Set the WIDTH to 800 pixels, the HEIGHT to 600 pixels, the RESOLUTION to 72 pixels/inch, the COLOUR MODE to RGB COLOUR, 8 BIT and the BACKGROUND COLOUR to WHITE.

- 3 Select OK to start the document.

Setting the Ruler and Grid Units

You will be using RULERS and a GRID to accurately create the box, so the settings need to be checked.

- 1 On the Windows system, display the EDIT menu, highlight PREFERENCES and select UNITS & RULERS. On the Macintosh system, display the PHOTOSHOP menu, highlight PREFERENCES and select UNITS & RULERS.

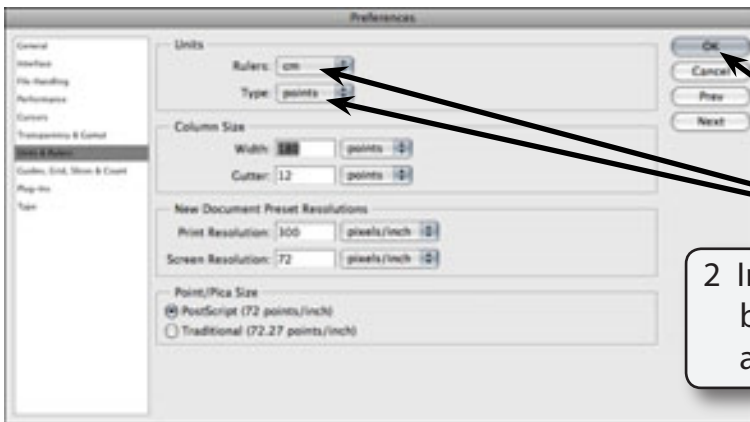

2 In the UNITS frame set the RULERS box to CM, the TYPE box to POINTS and select OK.

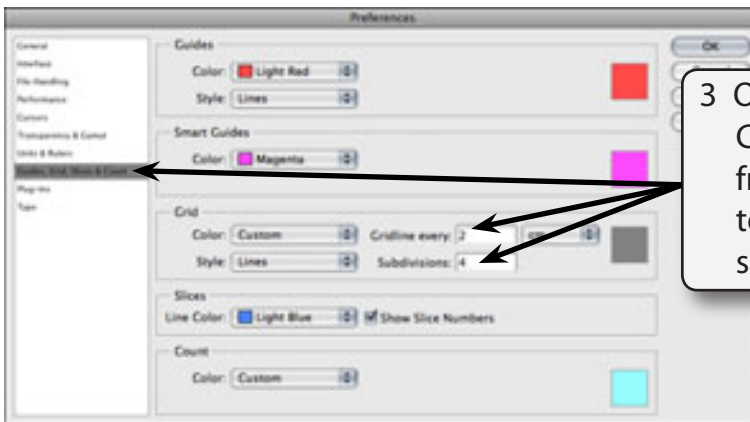

3 Open the GUIDES, GRID, SLICES & COUNT category and, in the GRID frame, set the GRIDLINE EVERY box to 2 cm, the SUBDIVISIONS to 4 and select OK.

NOTE: You can also use the GUIDES, GRID, SLICES & COUNT section to set the colour of the grid and guide lines.

Turning on the Rulers and Grid

- 1 Display the VIEW menu and select RULERS.

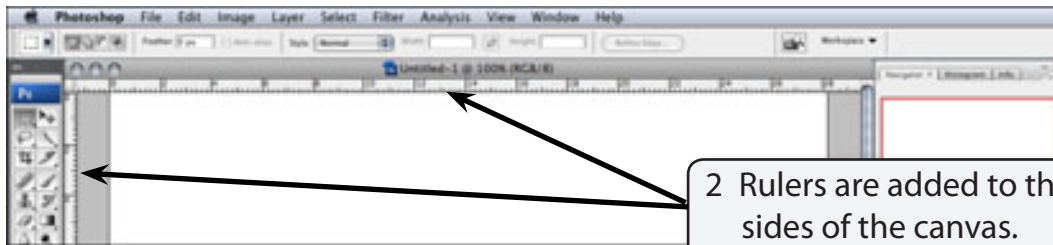

- 3 Display the VIEW menu again, highlight SHOW and select GRID.

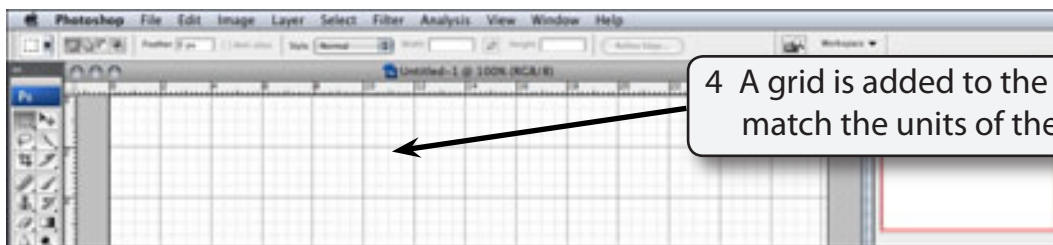

NOTE: You can **RIGHT+CLICK** or **CONTROL+CLICK** on the **RULERS** to quickly change their units

Setting Guide Lines

You can add guide lines to the canvas to help you layout a sketch. In this case guide lines will be needed for the front and side of the box.

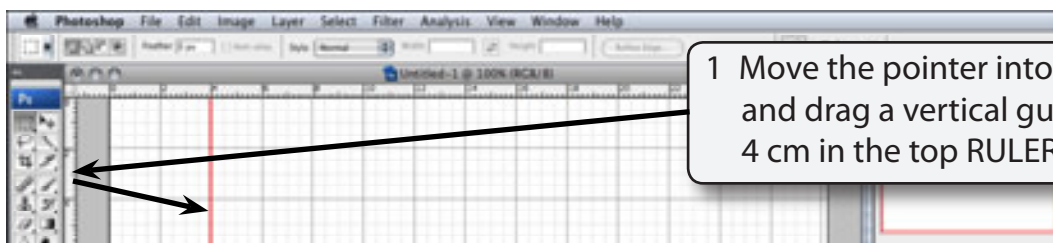

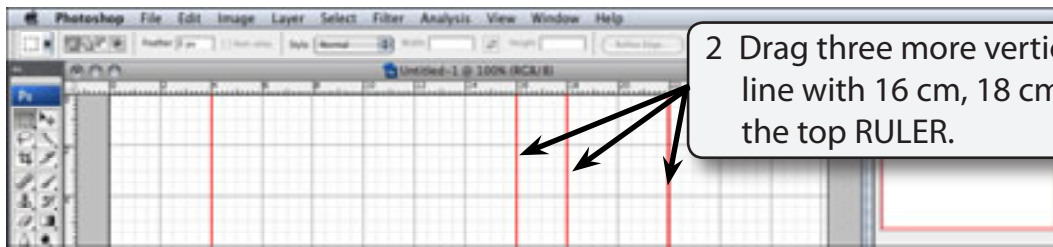

2 Drag three more vertical guides in line with 16 cm, 18 cm and 22cm in the top RULER.

NOTE: You can move guide lines to new positions by selecting the **MOVE TOOL**, moving the pointer over the guide line until it changes to parallel lines with arrows and dragging the guide line to a new position. Dragging a guide line back to its **RULER** removes the guide line from the screen.

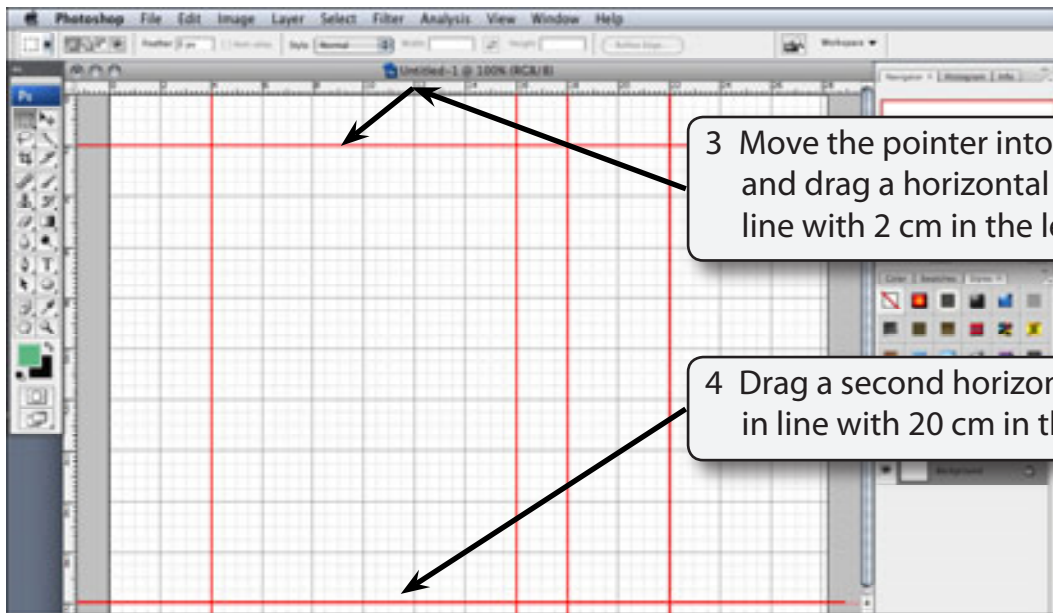

3 Move the pointer into the top RULER and drag a horizontal guide line in line with 2 cm in the left RULER

4 Drag a second horizontal guide line in line with 20 cm in the left RULER

Creating the Front of the Box

A Setting a Green Rectangle

A rectangular selection frame will added to the canvas and filled to green so that it has no border.

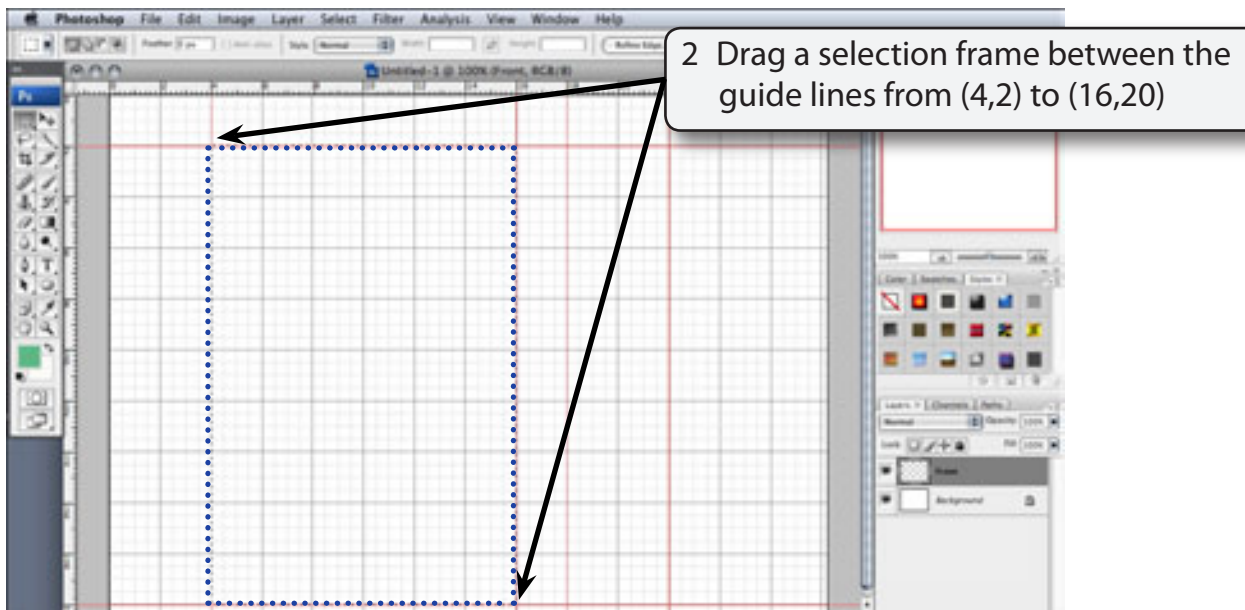
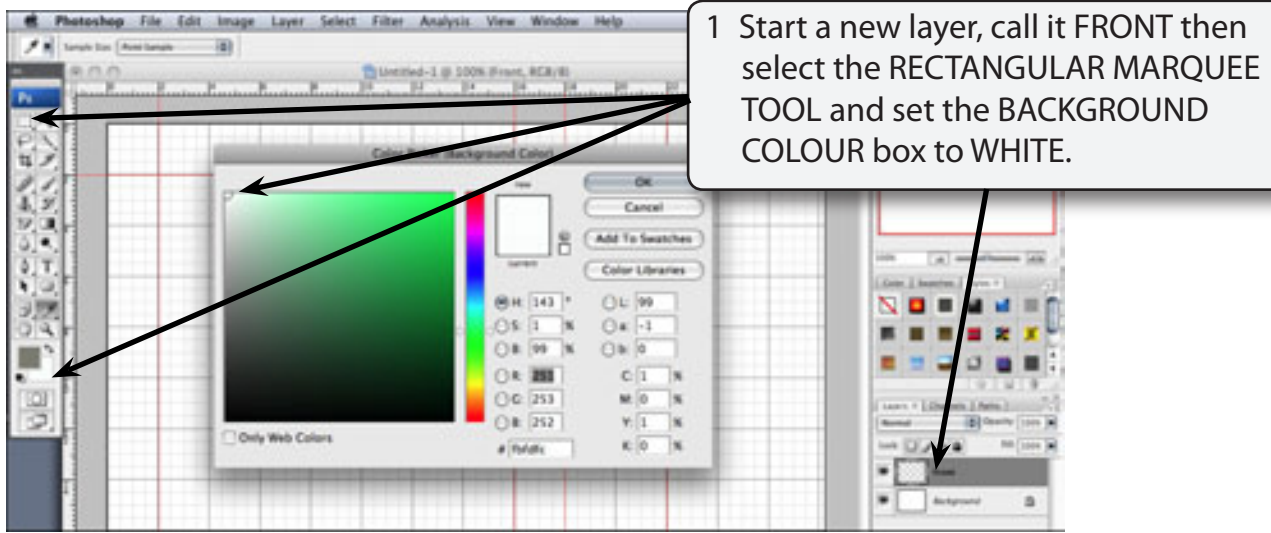

3 Display the EDIT menu and select FILL.