

# Animating Objects

You can create three dimensional animations from flat surfaces. To illustrate this a rotating planet will be created from a rectangle.

## Starting a New Document

- 1 Load Photoshop, display the FILE menu and select NEW.

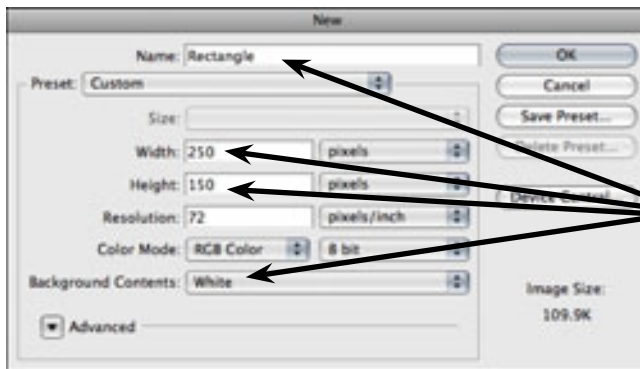

- 2 Call the document: RECTANGLE, set the WIDTH to 250 pixels, the HEIGHT to 150 pixels and the BACKGROUND COLOUR to WHITE.

- 3 Select OK to start the document.

## Creating a Filled Rectangle

The spherical planet will be created from a gradient filled rectangle.

### A Setting the layer

The background layer will be unlocked then filled.

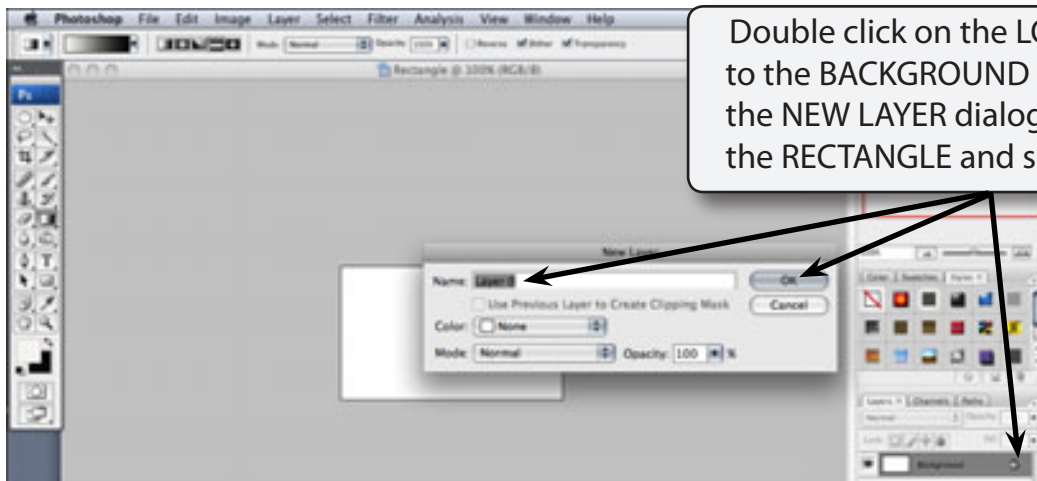

- Double click on the LOCK icon next to the BACKGROUND layer to display the NEW LAYER dialogue box, rename the RECTANGLE and select OK.

## B Filling the Canvas

The canvas can now be filled with gradient colours.

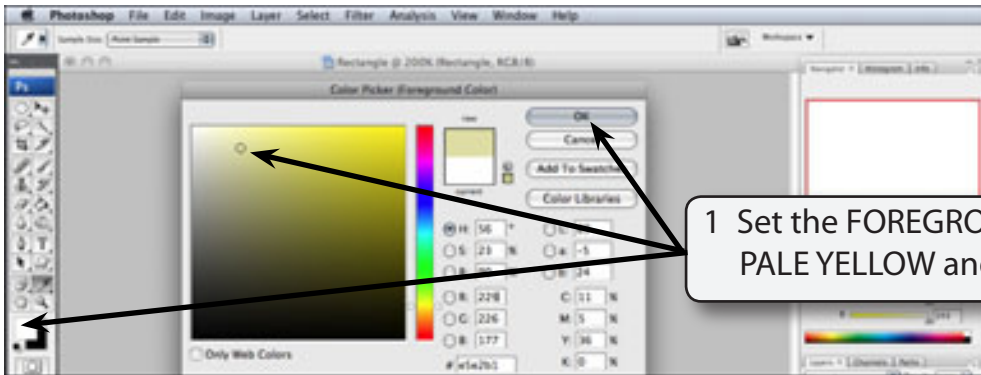

1 Set the FOREGROUND COLOUR to a PALE YELLOW and select OK.

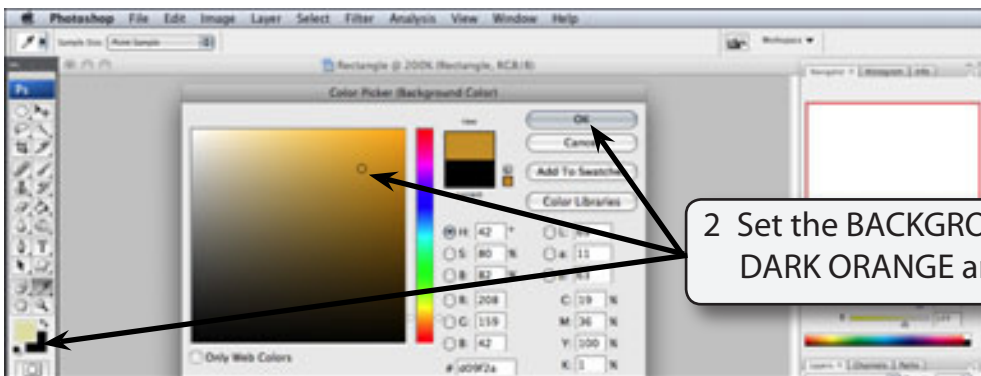

2 Set the BACKGROUND COLOUR to a DARK ORANGE and select OK.

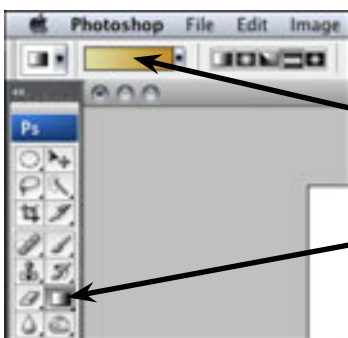

3 Select the GRADIENT TOOL and click on the GRADIENT box in the OPTIONS BAR to display the GRADIENT EDITOR dialogue box.

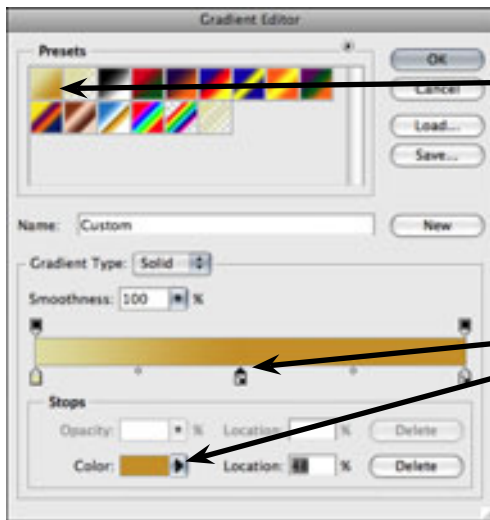

4 Select the FOREGROUND TO BACKGROUND gradient preset.

5 Click on the centre of the base of the gradient colour bar to insert a COLOUR STOP MARKER and set the COLOUR box to BACKGROUND COLOUR.

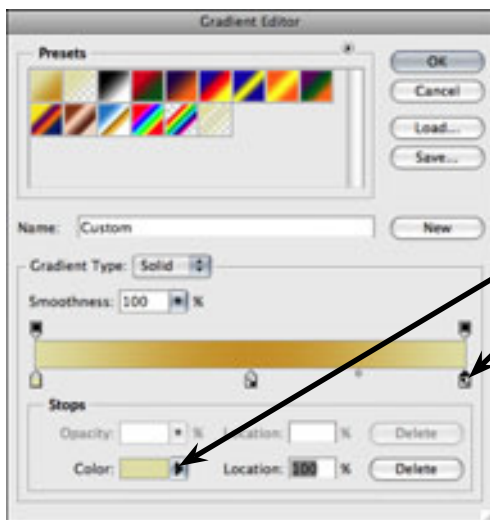

6 Click on the right COLOUR STOP MARKER and set its COLOUR to FOREGROUND COLOUR.

**NOTE:**

- i This has set the gradient to fade from the foreground colour to the background colour then back to the foreground colour.
- ii You can add numerous COLOUR STOP MARKERS to the gradient colour bar to create the gradient you want.

7 Select OK to set the gradient.

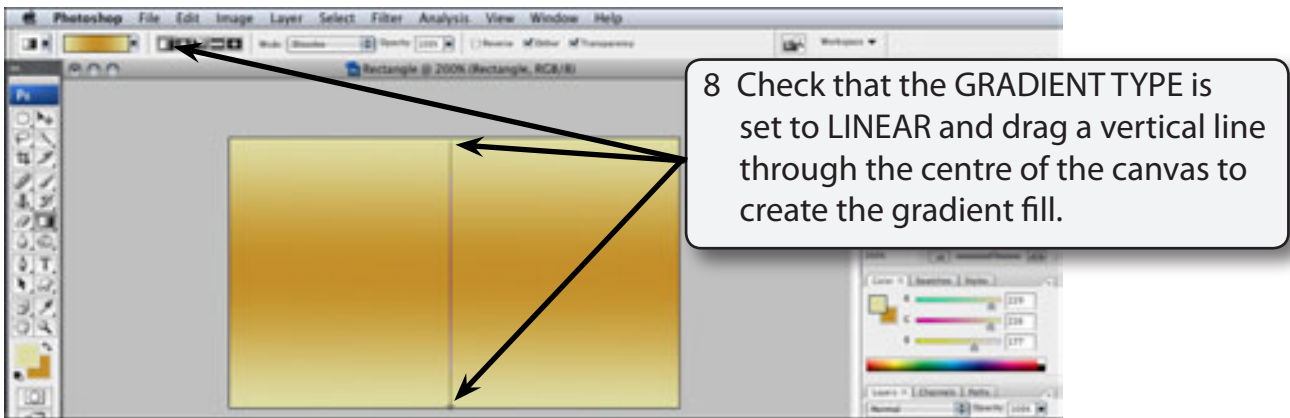

- 9 Save the file in you STORAGE folder as a PHOTOSHOP file under the file name:  
Rectangle

## C Adding Some Surface Marks

The BURN and DODGE TOOLS can be used to add some marks to the surface.

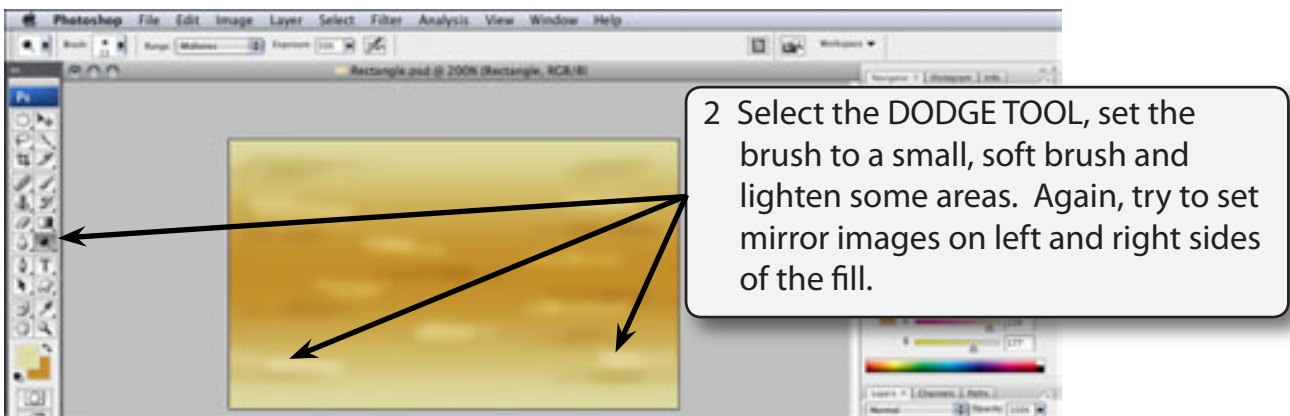
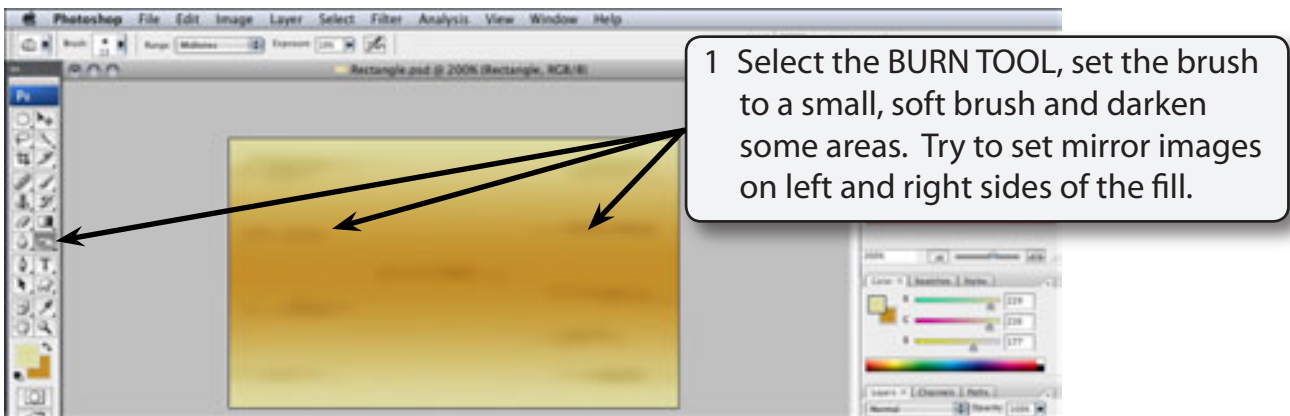

## Creating a Smart Object

We want to produce an independent animation within a layer which can be added to other files. A SMART OBJECT LAYER can be used to achieve this without destroying the rectangle.

### A Setting the Animation File

A separate file is used to create the animation.

- 1 Display the FILE menu and select NEW.

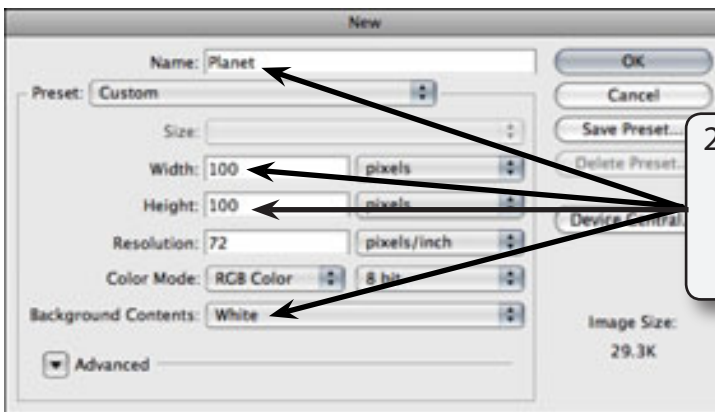

2 Call the document: PLANET, set the WIDTH to 100 pixels, the HEIGHT to 100 pixels and the BACKGROUND COLOUR to WHITE.

- NOTE:**
- i The object is going to be converted into a sphere, so the WIDTH and HEIGHT of the document need to be the same.
  - ii The HEIGHT has been set to lower than the HEIGHT of the RECTANGLE file so that all the fill will be displayed.

- 3 Select OK to start the document.